



## DE-0183-SAT

V0

### LINUX

#### Description

For downlighting. Warranty: 2 Years.

	Finish	Material
Structure	Satin nickel	Steel

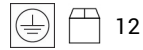
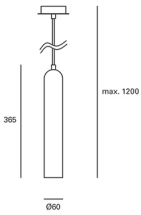

#### TECHNICAL CHARACTERISTICS

##### Light source

Lampholder: 1 x GU10  
Output (W): MAX 7W  
Total power consumption (W): 7  
Lamp maximum dimension: 58/50 mm  
Real Lumen: 352  
Quantity: 1  
Lm/Real W: 50  
UGR: 16.6  
Recommended lamp: GU10

##### GEAR

Voltage / Frequency:  
100-240VAC/50-60Hz

##### Luminaire

Warranty: 2 Years

##### Logistics

Energy Efficiency: NO BULB  
EAN Code: 8435381449230  
Net Weight (Kg): 0.760  
Weight in Kg (packaged): 1.000  
Packing: 110 x 110 x 440  
Masterbox: 12

The photograph may not match the reference exactly. Please read the product description to identify the finish.

**Luminaire**

Code DE-0183-BLA  
Name Colgante led 5W GU10

**Measur.**

Code DE-0181-BLA  
Name Colgante led 5W GU10

Luminaire Flux	352.00 lm	Luminaire Power	5.00 W	Efficacy	70.40 lm/W	Efficiency	100.00%
Lamps Flux	352.00 lm	Maximum value	2459.92 cd/klm	Position	C=0.00 G=0.00	CG Double Symmetrical	
Round Luminaire Round Luminous Area		Diam. Diam.	60 mm 42 mm	Height Height	350 mm 0 mm		
Horizontal Luminous Area Emitting area on Plane 0° Emitting area on Plane 90°		0.001385 m2 0.000000 m2 0.000000 m2		Emitting area on Plane 180° Emitting area on Plane 270° Glare area at 76°		0.000000 m2 0.000000 m2 0.000335 m2	
Coordinate system Date Measurement Distance		CG 25-08-2016 0.00		Symmetry Type Maximum Gamma Angle Measurement Flux		Double Symmetrical 90 352.00 lm	
Operator Temperature Humidity Notes		Asselum T3 25.00 °C 60.00 %		Source Voltage [V] Source current [A] Photocell			

Line		Code	Luminaire Lamps		Flux [lm]	Pow. [W]	Q.ty
		LED STAR 5W GU10	Name LED STAR 5W GU10		352.00	5.00	1
C.I.E.	91 97 99 100 100		D DIN 5040		A60		
F UTE	1.00 A		B NBN		BZ 1		

Diam=60mm

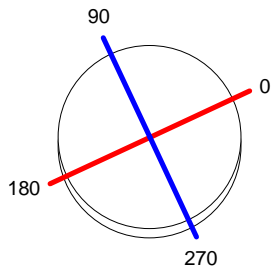

C Halfplanes  
180.0 — 0.0  
270.0 — 90.0

ULOR 0.00 %  
DLOR 100.00 %  
RN 0.00 %

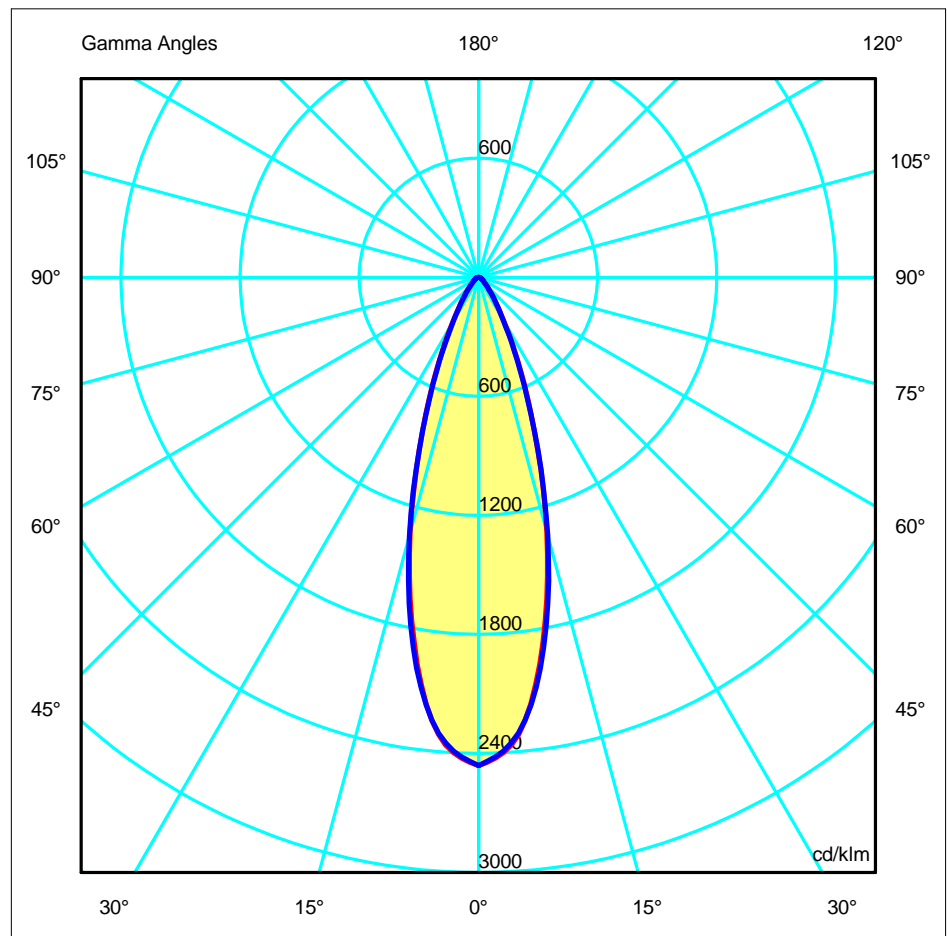



**Luminaire**

Code DE-0183-BLA  
Name Colgante led 5W GU10

**Measur.**

Code DE-0181-BLA  
Name Colgante led 5W GU10

Luminaire Flux	352.00 lm	Luminaire Power	5.00 W	Efficacy	70.40 lm/W	Efficiency	100.00%
Lamps Flux	352.00 lm	Maximum value	2459.92 cd/klm	Position	C=0.00 G=0.00	CG	Double Symmetrical

**Luminous Intensity Table cd/klm Table 1/1**

	C 0.00	C 15.00	C 30.00	C 45.00	C 60.00	C 75.00	C 90.00
G 0.0	2459.92	2459.92	2459.92	2459.92	2459.92	2459.92	2459.92
G 5.0	2312.46	2300.79	2297.90	2307.07	2304.79	2310.51	2306.05
G 10.0	1868.08	1875.71	1887.28	1889.05	1891.38	1906.13	1893.38
G 15.0	1328.47	1316.03	1314.76	1328.21	1330.50	1344.26	1346.01
G 20.0	824.04	818.02	812.54	817.03	824.71	834.53	822.02
G 25.0	475.26	467.29	457.27	468.64	469.25	467.89	463.95
G 30.0	257.50	255.27	253.34	256.25	259.09	257.92	249.41
G 35.0	143.63	144.11	143.91	147.36	145.53	146.18	144.99
G 40.0	84.62	86.45	85.50	87.10	86.70	86.84	85.84
G 45.0	53.56	54.38	54.18	55.48	55.16	55.48	54.66
G 50.0	37.02	36.63	37.05	37.74	37.77	37.58	37.30
G 55.0	26.61	26.76	27.05	27.27	27.14	27.53	27.75
G 60.0	20.61	20.88	20.91	20.91	20.91	21.04	20.72
G 65.0	16.85	16.57	16.43	16.74	16.76	16.70	16.47
G 70.0	12.99	12.96	12.81	12.96	12.97	12.77	12.59
G 75.0	9.64	9.77	9.56	9.57	9.59	9.95	9.61
G 80.0	6.32	6.45	6.35	6.40	6.29	6.59	6.42
G 85.0	3.46	3.48	3.35	3.41	3.55	3.61	3.69
G 90.0	1.50	1.48	1.49	1.53	1.60	1.70	1.74

**Luminaire**

Code DE-0183-BLA  
 Name Colgante led 5W GU10

**Measur.**

Code DE-0181-BLA  
 Name Colgante led 5W GU10

Luminaire Flux	352.00 lm	Luminaire Power	5.00 W	Efficacy	70.40 lm/W	Efficiency	100.00%
Lamps Flux	352.00 lm	Maximum value	2459.92 cd/klm	Position	C=0.00 G=0.00	CG	Double Symmetrical

Diam=60mm

C Halfplanes

180.0 ——— 0.0  
 270.0 ——— 90.0

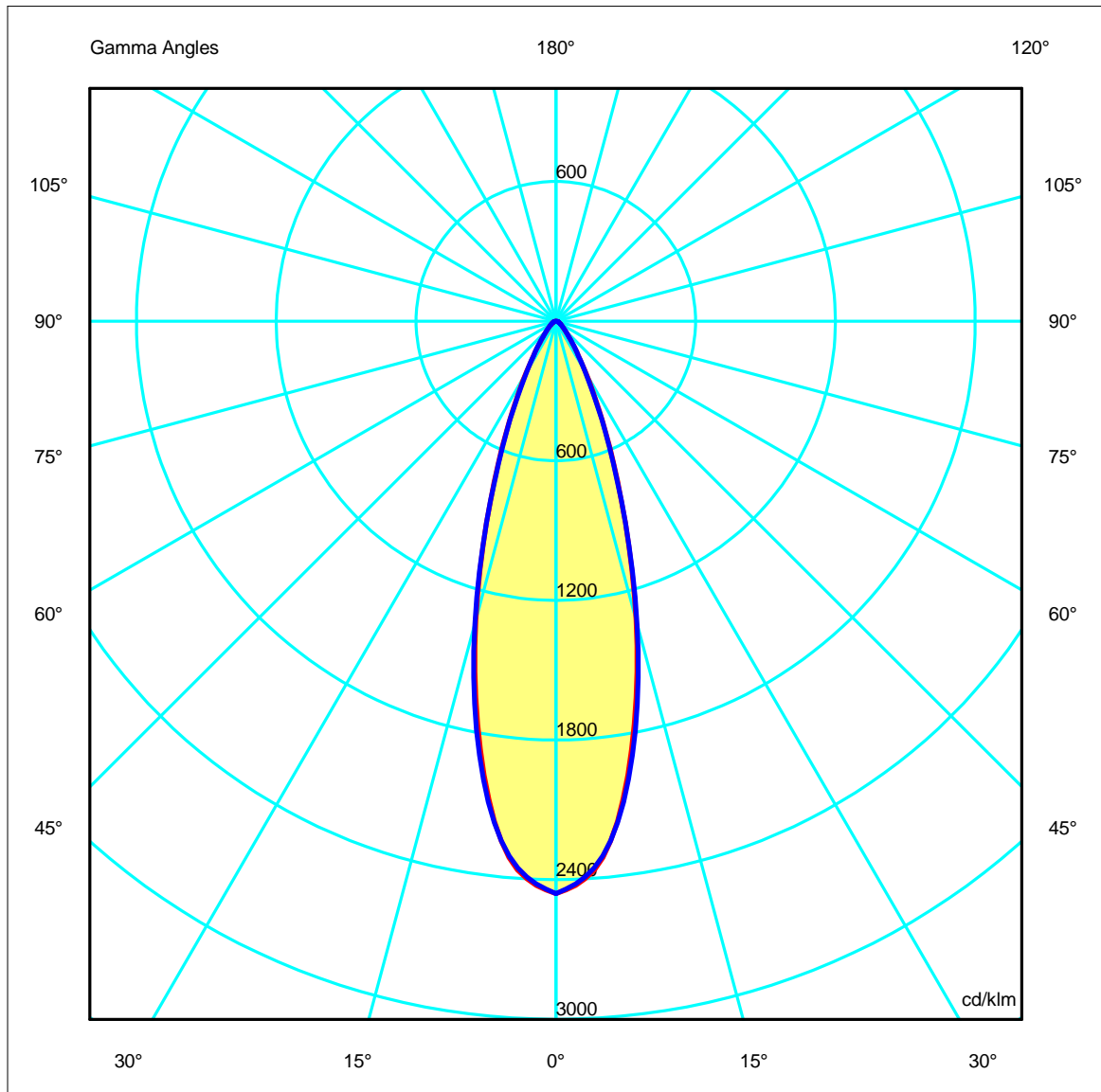
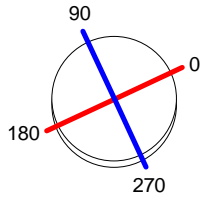

**Luminaire**

 Code DE-0183-BLA  
 Name Colgante led 5W GU10

**Measur.**

 Code DE-0181-BLA  
 Name Colgante led 5W GU10

Luminaire Flux	352.00 lm	Luminaire Power	5.00 W	Efficacy	70.40 lm/W	Efficiency	100.00%
Lamps Flux	352.00 lm	Maximum value	2459.92 cd/klm	Position	C=0.00 G=0.00	CG	Double Symmetrical

Width at 50.00 % of Max Intensity

H[m]	1.00	2.00	3.00	4.00	5.00	H[m]	1.00	2.00	3.00	4.00	5.00
OA	0.29	0.57	0.86	1.14	1.43	OC	0.29	0.57	0.86	1.15	1.44
OB	0.29	0.57	0.86	1.14	1.43	OD	0.29	0.57	0.86	1.15	1.44

	Luminous Intensities [ cd/klm]									
	0	5	15	25	35	45	55	65	75	85
OA	865.89	813.98	467.62	167.29	50.56	18.85	9.37	5.93	3.39	1.22
OB	865.89	813.98	467.62	167.29	50.56	18.85	9.37	5.93	3.39	1.22
OC	865.89	811.73	473.80	163.31	51.04	19.24	9.77	5.80	3.38	1.30
OD	865.89	811.73	473.80	163.31	51.04	19.24	9.77	5.80	3.38	1.30

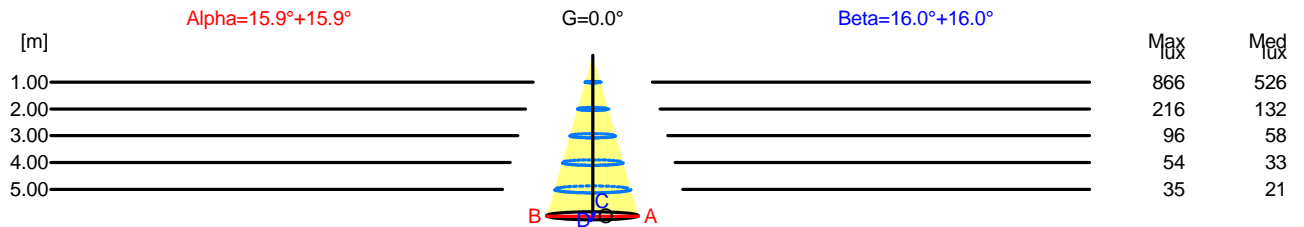

H[m]	D[m]	Max lux	Med lux	Alpha=15.9°+15.9°	G=0.0
1.00	0.57	866	526		
2.00	1.14	216	132		
3.00	1.71	96	58		
4.00	2.28	54	33		
5.00	2.85	35	21		

H[m]	D[m]	Max lux	Med lux	Beta=16.0°+16.0°	G=0.0
1.00	0.57	866	526		
2.00	1.15	216	132		
3.00	1.72	96	58		
4.00	2.30	54	33		
5.00	2.87	35	21		



**Luminaire**

Code DE-0183-BLA  
Name Colgante led 5W GU10

**Measurement**

Code DE-0181-BLA  
Name Colgante led 5W GU10

Luminaire Flux	352.00 lm	Luminaire Power	5.00 W	Efficacy	70.40 lm/W	Efficiency	100.00%
Lamps Flux	352.00 lm	Maximum value	2459.92 cd/klm	Position	C=0.00 G=0.00	CG	Double Symmetrical

**UGR**  
S = 0.250

Reflectancies										
Ceiling/Cavity	0.7	0.7	0.5	0.5	0.3	0.7	0.7	0.5	0.5	0.3
Walls	0.5	0.3	0.5	0.3	0.3	0.5	0.3	0.5	0.3	0.3
WorkingPlane	0.2	0.2	0.2	0.2	0.2	0.2	0.2	0.2	0.2	0.2
RoomDimensions	ViewedCrosswise					ViewedEndwise				
x=2H y=2H	16.6	17.4	16.9	17.6	17.8	16.7	17.4	16.9	17.6	17.8
x=2H y=3H	17.4	18.1	17.7	18.3	18.6	17.5	18.2	17.8	18.4	18.6
x=2H y=4H	17.9	18.5	18.2	18.8	19.1	17.9	18.5	18.2	18.8	19.1
x=2H y=6H	18.3	18.9	18.6	19.1	19.5	18.3	18.9	18.6	19.2	19.5
x=2H y=8H	18.4	19.0	18.8	19.3	19.7	18.5	19.1	18.8	19.3	19.7
x=2H y=12H	18.6	19.1	18.9	19.4	19.8	18.6	19.2	19.0	19.5	19.8
x=4H y=2H	16.9	17.6	17.2	17.8	18.2	17.0	17.6	17.3	17.9	18.2
x=4H y=3H	18.0	18.5	18.3	18.8	19.2	18.0	18.5	18.4	18.9	19.2
x=4H y=4H	18.6	19.0	18.9	19.4	19.8	18.6	19.1	19.0	19.4	19.8
x=4H y=6H	19.1	19.5	19.5	19.9	20.3	19.2	19.6	19.6	19.9	20.3
x=4H y=8H	19.4	19.7	19.8	20.1	20.6	19.4	19.8	19.9	20.2	20.6
x=4H y=12H	19.6	19.9	20.0	20.3	20.8	19.7	20.0	20.1	20.4	20.8
x=8H y=4H	18.8	19.2	19.3	19.6	20.0	18.9	19.2	19.3	19.6	20.0
x=8H y=6H	19.5	19.8	20.0	20.2	20.7	19.6	19.8	20.0	20.3	20.7
x=8H y=8H	19.8	20.1	20.3	20.5	21.0	19.9	20.1	20.4	20.6	21.0
x=8H y=12H	20.2	20.3	20.6	20.8	21.4	20.2	20.4	20.7	20.9	21.4
x=12H y=4H	18.9	19.2	19.3	19.6	20.0	18.9	19.2	19.3	19.6	20.0
x=12H y=6H	19.6	19.8	20.1	20.3	20.8	19.6	19.9	20.1	20.3	20.8
x=12H y=8H	20.0	20.2	20.4	20.6	21.2	20.0	20.2	20.5	20.7	21.2

**Luminaire**

Code DE-0183-BLA  
 Name Colgante led 5W GU10

**Measur.**

Code DE-0181-BLA  
 Name Colgante led 5W GU10

Luminaire Flux	352.00 lm	Luminaire Power	5.00 W	Efficacy	70.40 lm/W	Efficiency	100.00%
Lamps Flux	352.00 lm	Maximum value	2459.92 cd/klm	Position	C=0.00 G=0.00	CG	Double Symmetrical

Diam=60mm

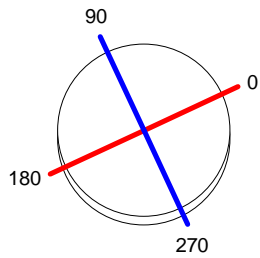

C Halfplanes

180.0 ———— 0.0  
 270.0 ———— 90.0

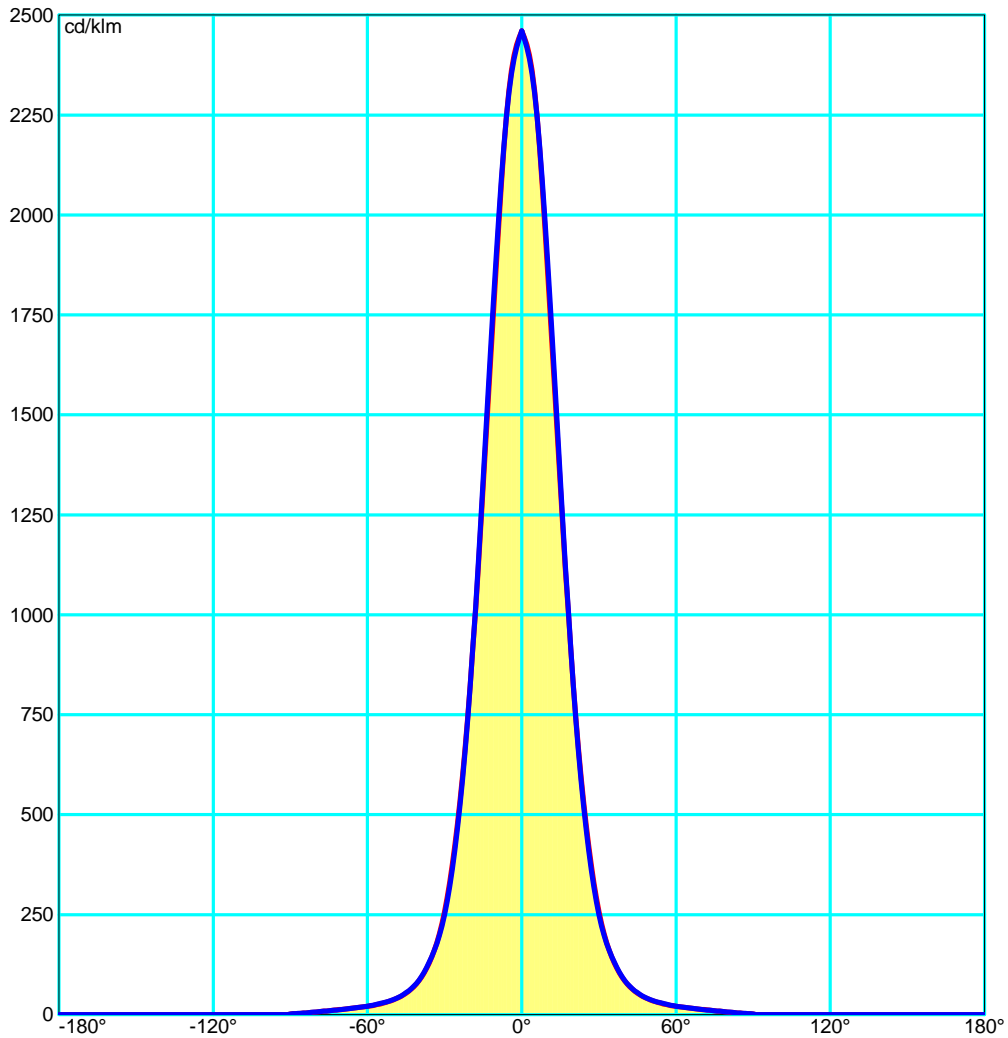

**Luminaire**  
 Code DE-0183-BLA  
 Name Colgante led 5W GU10  
**Measur.**  
 Code DE-0181-BLA  
 Name Colgante led 5W GU10

Luminaire Flux	352.00 lm	Luminaire Power	5.00 W	Efficacy	70.40 lm/W	Efficiency	100.00%
Lamps Flux	352.00 lm	Maximum value	2459.92 cd/klm	Position	C=0.00 G=0.00	CG	Double Symmetrical

Luminance

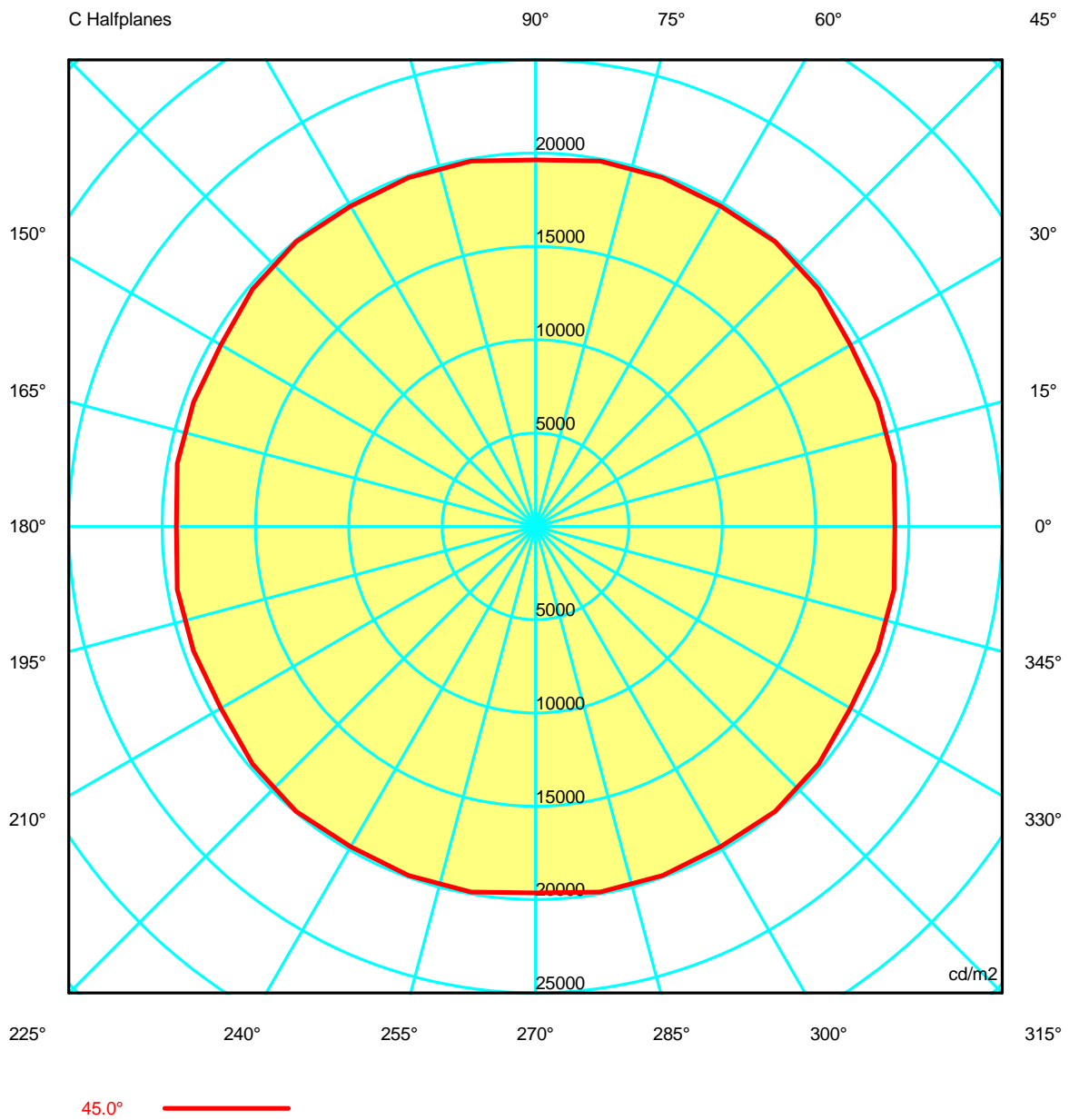





**Luminaire**

Code DE-0183-BLA  
Name Colgante led 5W GU10

**Measur.**

Code DE-0181-BLA  
Name Colgante led 5W GU10

Luminaire Flux	352.00 lm	Luminaire Power	5.00 W	Efficacy	70.40 lm/W	Efficiency	100.00%
Lamps Flux	352.00 lm	Maximum value	2459.92 cd/klm	Position	C=0.00 G=0.00	CG	Double Symmetrical

**Luminance cd/m2 Table 1/3**

	C 0.00	C 10.00	C 20.00	C 30.00	C 40.00	C 50.00	C 60.00	C 70.00	C 80.00	C 90.00	C 100.00	C 110.00	C 120.00
G 0.0	624994.08	624994.08	624994.08	624994.08	624994.08	624994.08	624994.08	624994.08	624994.08	624994.08	624994.08	624994.08	624994.08
G 5.0	589771.07	587673.74	586138.89	586058.28	587781.45	588354.45	587817.04	588815.03	589232.29	588137.34	589232.29	588815.03	587817.04
G 10.0	481945.14	483098.05	484959.69	486899.86	487203.47	487556.26	487958.21	490873.16	491447.34	488472.17	491447.34	490873.16	487958.21
G 15.0	349432.75	347090.74	345531.62	345826.45	348339.51	349666.04	349965.33	352389.48	353738.80	354045.33	353738.80	352389.48	349965.33
G 20.0	222801.30	221770.98	220514.36	219690.49	220325.30	221467.24	222980.88	225190.42	225122.61	222253.82	225122.61	225190.42	222980.88
G 25.0	133233.04	131981.13	129710.45	128188.16	130210.22	131433.02	131548.31	131308.46	130887.04	130062.07	130887.04	131308.46	131548.31
G 30.0	75545.29	75135.78	74613.58	74324.48	74801.32	75524.47	76011.54	76012.98	75020.40	73170.38	75020.40	76012.98	76011.54
G 35.0	44547.69	44711.00	44676.44	44636.48	45440.98	45628.63	45136.54	45241.16	45308.63	44971.39	45308.63	45241.16	45136.54
G 40.0	28065.52	28588.38	28576.77	28355.79	28710.75	28843.27	28755.85	28791.19	28740.81	28470.25	28740.81	28791.19	28755.85
G 45.0	19244.12	19497.07	19503.01	19468.24	19798.97	19939.82	19819.63	19901.96	19886.91	19639.36	19886.91	19901.96	19819.63
G 50.0	14631.28	14501.35	14497.90	14644.32	14845.82	14948.98	14929.57	14884.12	14822.19	14744.64	14822.19	14884.12	14929.57
G 55.0	11786.36	11824.98	11890.02	11982.94	12066.76	12056.92	12023.12	12126.96	12239.67	12290.10	12239.67	12126.96	12023.12
G 60.0	10474.43	10577.29	10615.43	10624.92	10625.56	10624.89	10622.88	10668.79	10662.80	10530.47	10662.80	10668.79	10622.88
G 65.0	10128.43	10015.82	9907.09	9876.66	10000.10	10086.88	10074.17	10059.67	10005.81	9900.97	10005.81	10059.67	10074.17
G 70.0	9652.76	9634.89	9580.56	9513.24	9582.89	9656.06	9634.84	9538.35	9435.52	9355.39	9435.52	9538.35	9634.84
G 75.0	9460.88	9583.08	9532.08	9388.48	9392.53	9402.61	9418.70	9685.39	9735.22	9437.45	9735.22	9685.39	9418.70
G 80.0	9252.46	9412.73	9392.35	9295.02	9363.54	9296.30	9205.93	9507.98	9641.97	9391.56	9641.97	9507.98	9205.93
G 85.0	10100.93	10177.94	10019.19	9771.35	9832.95	10098.25	10355.77	10480.12	10587.49	10742.73	10587.49	10480.12	10355.77
G 90.0	0.00	0.00	0.00	0.00	0.00	0.00	0.00	0.00	0.00	0.00	0.00	0.00	0.00



**Luminaire**

Code DE-0183-BLA  
Name Colgante led 5W GU10

**Measur.**

Code DE-0181-BLA  
Name Colgante led 5W GU10

Luminaire Flux	352.00 lm	Luminaire Power	5.00 W	Efficacy	70.40 lm/W	Efficiency	100.00%
Lamps Flux	352.00 lm	Maximum value	2459.92 cd/klm	Position	C=0.00 G=0.00	CG	Double Symmetrical

**Luminance cd/m2 Table 2/3**

	C 130.00	C 140.00	C 150.00	C 160.00	C 170.00	C 180.00	C 190.00	C 200.00	C 210.00	C 220.00	C 230.00	C 240.00	C 250.00
G 0.0	624994.08	624994.08	624994.08	624994.08	624994.08	624994.08	624994.08	624994.08	624994.08	624994.08	624994.08	624994.08	624994.08
G 5.0	588354.45	587781.45	586058.28	586138.89	587673.74	589771.07	587673.74	586138.89	586058.28	587781.45	588354.45	587817.04	588815.03
G 10.0	487556.26	487203.47	486899.86	484959.69	483098.05	481945.14	483098.05	484959.69	486899.86	487203.47	487556.26	487958.21	490873.16
G 15.0	349666.04	348339.51	345826.45	345531.62	347090.74	349432.75	347090.74	345531.62	345826.45	348339.51	349666.04	349965.33	352389.48
G 20.0	221467.24	220325.30	219690.49	220514.36	221770.98	222801.30	221770.98	220514.36	219690.49	220325.30	221467.24	222980.88	225190.42
G 25.0	131433.02	130210.22	128188.16	129710.45	131981.13	133233.04	131981.13	129710.45	128188.16	130210.22	131433.02	131548.31	131308.46
G 30.0	75524.47	74801.32	74324.48	74613.58	75135.78	75545.29	75135.78	74613.58	74324.48	74801.32	75524.47	76011.54	76012.98
G 35.0	45628.63	45440.98	44636.48	44676.44	44711.00	44547.69	44711.00	44676.44	44636.48	45440.98	45628.63	45136.54	45241.16
G 40.0	28843.27	28710.75	28355.79	28576.77	28588.38	28065.52	28588.38	28576.77	28355.79	28710.75	28843.27	28755.85	28791.19
G 45.0	19939.82	19798.97	19468.24	19503.01	19497.07	19244.12	19497.07	19503.01	19468.24	19798.97	19939.82	19819.63	19901.96
G 50.0	14948.98	14845.82	14644.32	14497.90	14501.35	14631.28	14501.35	14497.90	14644.32	14845.82	14948.98	14929.57	14884.12
G 55.0	12056.92	12066.76	11982.94	11890.02	11824.98	11786.36	11824.98	11890.02	11982.94	12066.76	12056.92	12023.12	12126.96
G 60.0	10624.89	10625.56	10624.92	10615.43	10577.29	10474.43	10577.29	10615.43	10624.92	10625.56	10624.89	10622.88	10668.79
G 65.0	10086.88	10000.10	9876.66	9907.09	10015.82	10128.43	10015.82	9907.09	9876.66	10000.10	10086.88	10074.17	10059.67
G 70.0	9656.06	9582.89	9513.24	9580.56	9634.89	9652.76	9634.89	9580.56	9513.24	9582.89	9656.06	9634.84	9538.35
G 75.0	9402.61	9392.53	9388.48	9532.08	9583.08	9460.88	9583.08	9532.08	9388.48	9392.53	9402.61	9418.70	9685.39
G 80.0	9296.30	9363.54	9295.02	9392.35	9412.73	9252.46	9412.73	9392.35	9295.02	9363.54	9296.30	9205.93	9507.98
G 85.0	10098.25	9832.95	9771.35	10019.19	10177.94	10100.93	10177.94	10019.19	9771.35	9832.95	10098.25	10355.77	10480.12
G 90.0	0.00	0.00	0.00	0.00	0.00	0.00	0.00	0.00	0.00	0.00	0.00	0.00	0.00



**Luminaire**

Code DE-0183-BLA  
Name Colgante led 5W GU10

**Measur.**

Code DE-0181-BLA  
Name Colgante led 5W GU10

Luminaire Flux	352.00 lm	Luminaire Power	5.00 W	Efficacy	70.40 lm/W	Efficiency	100.00%
Lamps Flux	352.00 lm	Maximum value	2459.92 cd/klm	Position	C=0.00 G=0.00	CG	Double Symmetrical

**Luminance cd/m2 Table 3/3**

	C 260.00	C 270.00	C 280.00	C 290.00	C 300.00	C 310.00	C 320.00	C 330.00	C 340.00	C 350.00
G 0.0	624994.08	624994.08	624994.08	624994.08	624994.08	624994.08	624994.08	624994.08	624994.08	624994.08
G 5.0	589232.29	588137.34	589232.29	588815.03	587817.04	588354.45	587781.45	586058.28	586138.89	587673.74
G 10.0	491447.34	488472.17	491447.34	490873.16	487958.21	487556.26	487203.47	486899.86	484959.69	483098.05
G 15.0	353738.80	354045.33	353738.80	352389.48	349965.33	349666.04	348339.51	345826.45	345531.62	347090.74
G 20.0	225122.61	222253.82	225122.61	225190.42	222980.88	221467.24	220325.30	219690.49	220514.36	221770.98
G 25.0	130887.04	130062.07	130887.04	131308.46	131548.31	131433.02	130210.22	128188.16	129710.45	131981.13
G 30.0	75020.40	73170.38	75020.40	76012.98	76011.54	75524.47	74801.32	74324.48	74613.58	75135.78
G 35.0	45308.63	44971.39	45308.63	45241.16	45136.54	45628.63	45440.98	44636.48	44676.44	44711.00
G 40.0	28740.81	28470.25	28740.81	28791.19	28755.85	28843.27	28710.75	28355.79	28576.77	28588.38
G 45.0	19886.91	19639.36	19886.91	19901.96	19819.63	19939.82	19798.97	19468.24	19503.01	19497.07
G 50.0	14822.19	14744.64	14822.19	14884.12	14929.57	14948.98	14845.82	14644.32	14497.90	14501.35
G 55.0	12239.67	12290.10	12239.67	12126.96	12023.12	12056.92	12066.76	11982.94	11890.02	11824.98
G 60.0	10662.80	10530.47	10662.80	10668.79	10622.88	10624.89	10625.56	10624.92	10615.43	10577.29
G 65.0	10005.81	9900.97	10005.81	10059.67	10074.17	10086.88	10000.10	9876.66	9907.09	10015.82
G 70.0	9435.52	9355.39	9435.52	9538.35	9634.84	9656.06	9582.89	9513.24	9580.56	9634.89
G 75.0	9735.22	9437.45	9735.22	9685.39	9418.70	9402.61	9392.53	9388.48	9532.08	9583.08
G 80.0	9641.97	9391.56	9641.97	9507.98	9205.93	9296.30	9363.54	9295.02	9392.35	9412.73
G 85.0	10587.49	10742.73	10587.49	10480.12	10355.77	10098.25	9832.95	9771.35	10019.19	10177.94
G 90.0	0.00	0.00	0.00	0.00	0.00	0.00	0.00	0.00	0.00	0.00

**Luminaire**  
 Code DE-0183-BLA  
 Name Colgante led 5W GU10  
**Measur.**  
 Code DE-0181-BLA  
 Name Colgante led 5W GU10

Luminaire Flux	352.00 lm	Luminaire Power	5.00 W	Efficacy	70.40 lm/W	Efficiency	100.00%
Lamps Flux	352.00 lm	Maximum value	2459.92 cd/klm	Position	C=0.00 G=0.00	CG	Double Symmetrical

**PERCENTAGE ISOCANDLES**

Projection: Equal Area SLI (glare) 9.0 Tight Tilting Angle:0°

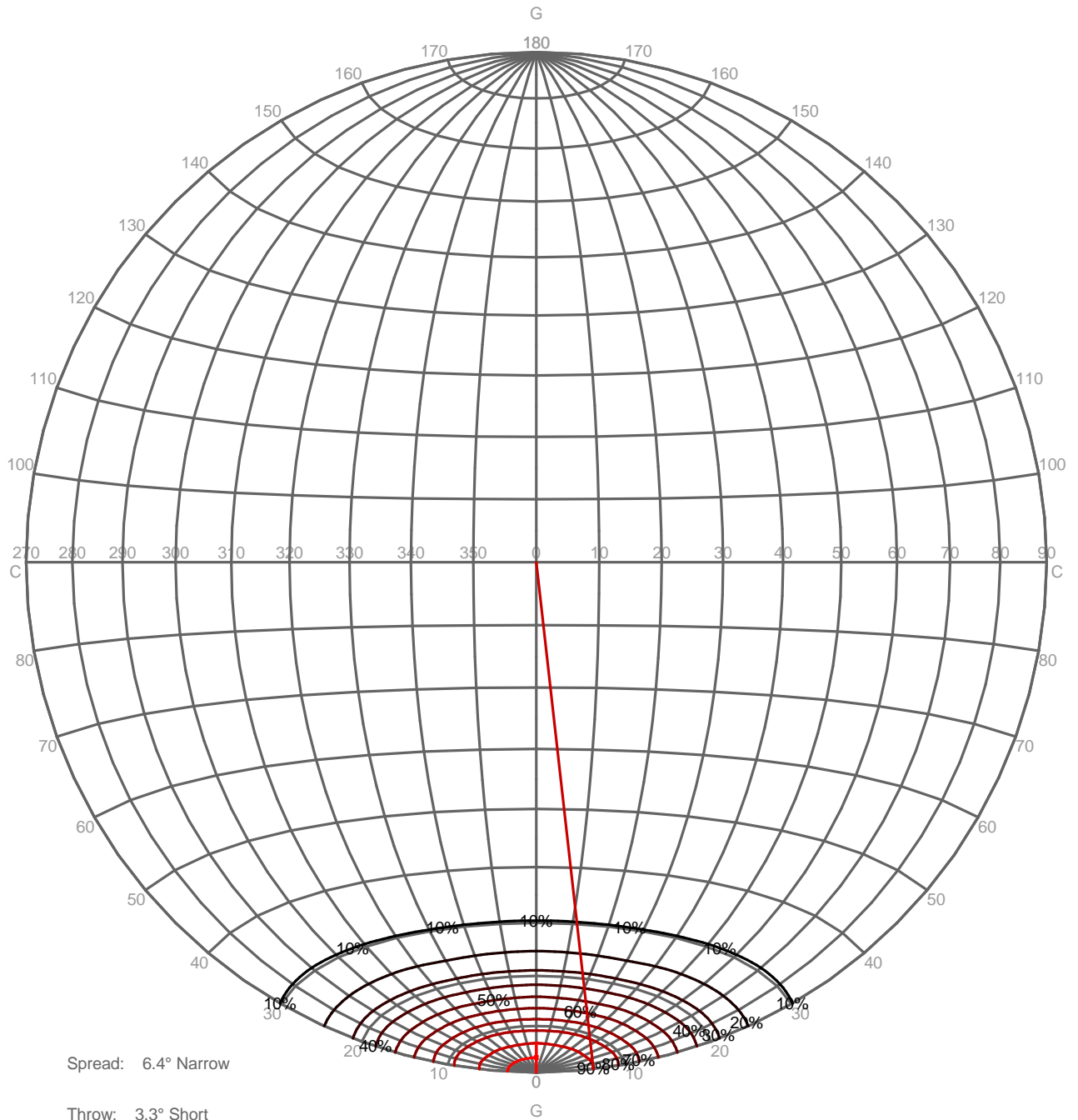

**Luminaire**

Code DE-0183-BLA  
 Name Colgante led 5W GU10

**Measur.**

Code DE-0181-BLA  
 Name Colgante led 5W GU10

Luminaire Flux	352.00 lm	Luminaire Power	5.00 W	Efficacy	70.40 lm/W	Efficiency	100.00%
Lamps Flux	352.00 lm	Maximum value	2459.92 cd/klm	Position	C=0.00 G=0.00	CG	Double Symmetrical

Isolux (Floor)

Luminaire position X=0.00m Y=0.00m Z=2.50m

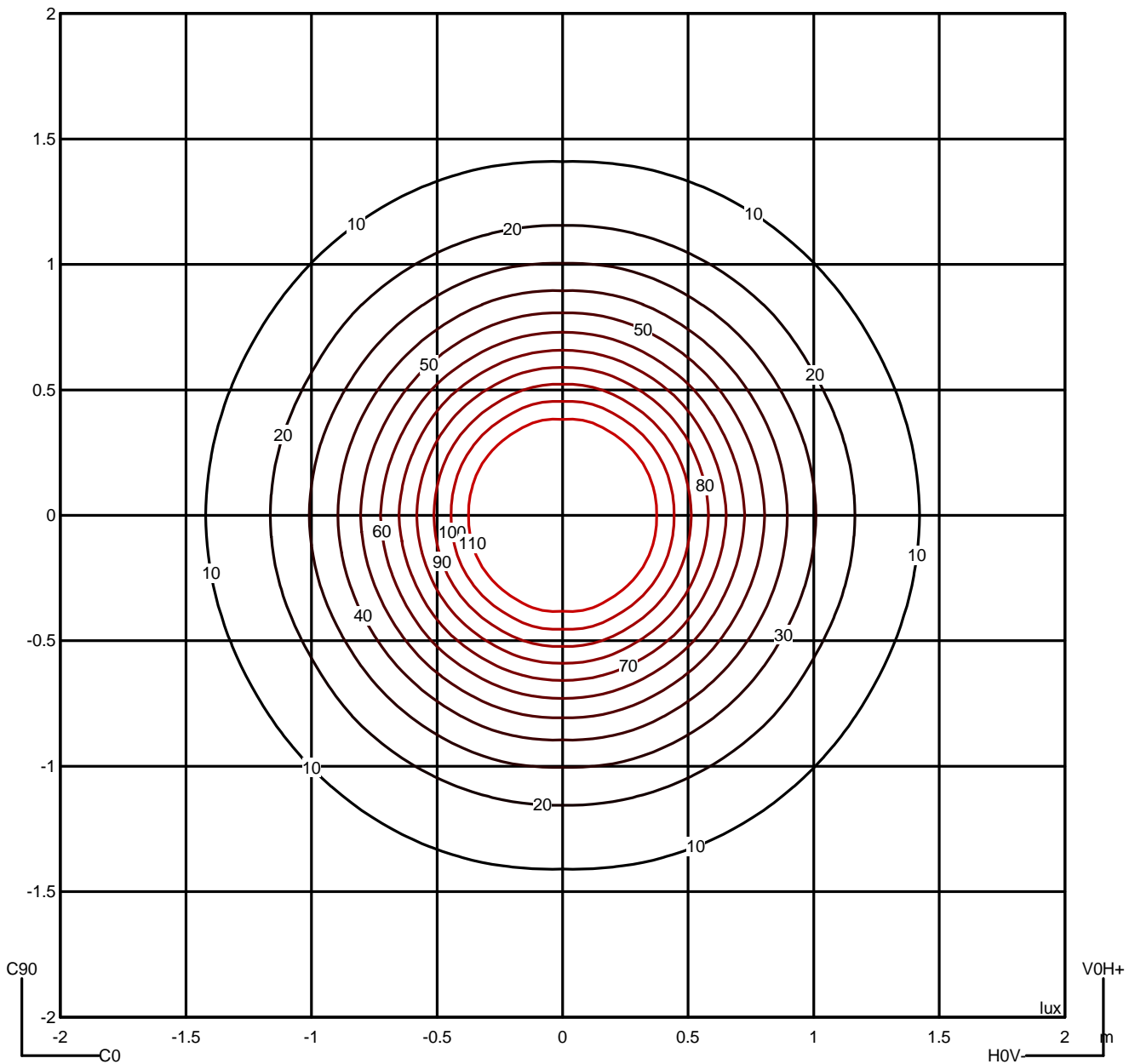

**Luminaire**  
 Code DE-0183-BLA  
 Name Colgante led 5W GU10  
**Measur.**  
 Code DE-0181-BLA  
 Name Colgante led 5W GU10

Luminaire Flux	352.00 lm	Luminaire Power	5.00 W	Efficacy	70.40 lm/W	Efficiency	100.00%
Lamps Flux	352.00 lm	Maximum value	2459.92 cd/klm	Position	C=0.00 G=0.00	CG	Double Symmetrical

		Average Luminance [cd/m <sup>2</sup> ]									
		45°	50°	55°	60°	65°	70°	75°	80°	85°	
0.0°	19244	14631	11786	10474	10128	9653	9461	9252	10101	---	
90.0°	19639	14745	12290	10530	9901	9355	9437	9392	10743	---	

Flush mounted or longitudinal view												
		Illumination(Ix)										
A	A	2000	1000	750	500		<300				1.15	
B	1		2000	1500	1000	750	500	<300			1.5	
C					2000		1000	500	<300		1.85	
D	2						2000	1000	500	<300	2.2	
E	3							2000	1000	500	<300	2.55

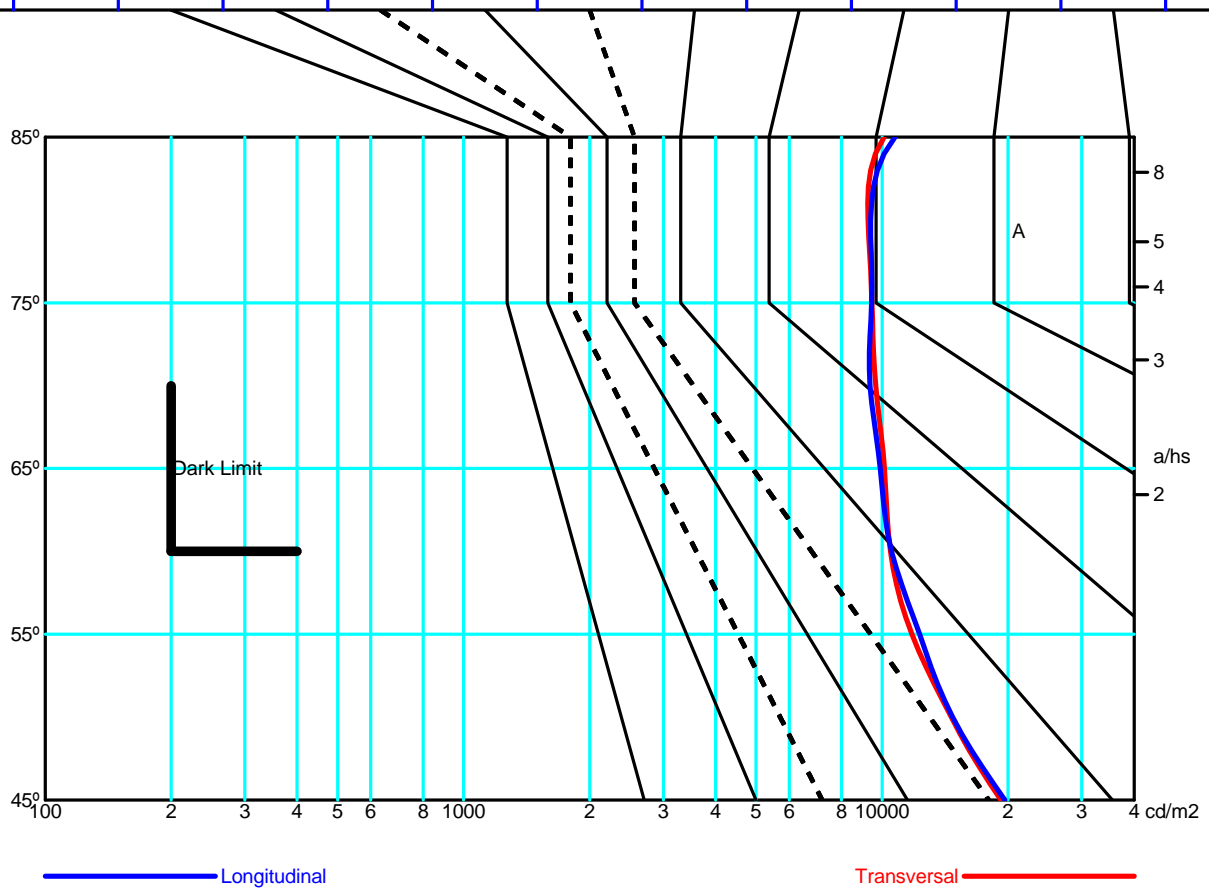

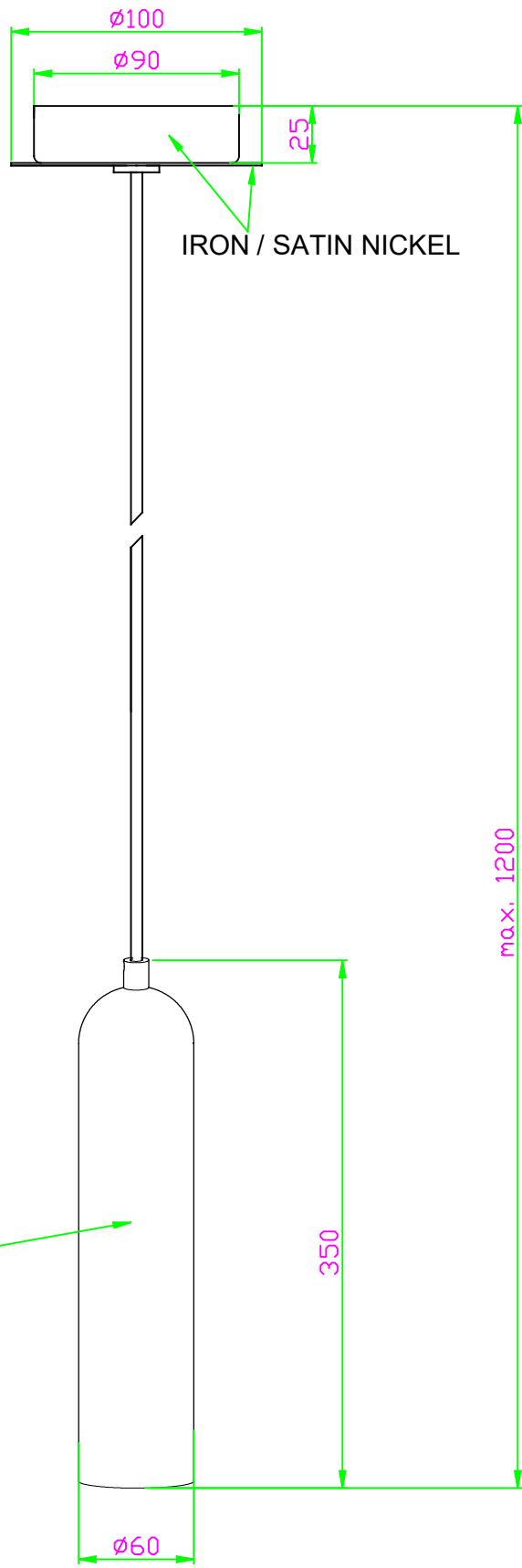
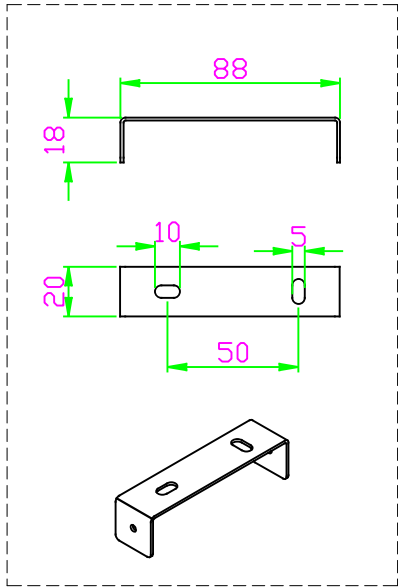

IRON / SATIN NICKEL

IRON / SATIN NICKEL

**1**

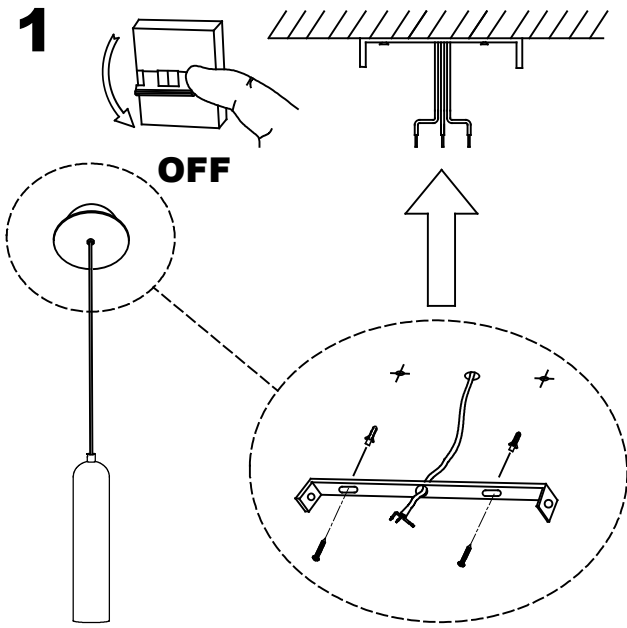

**2**

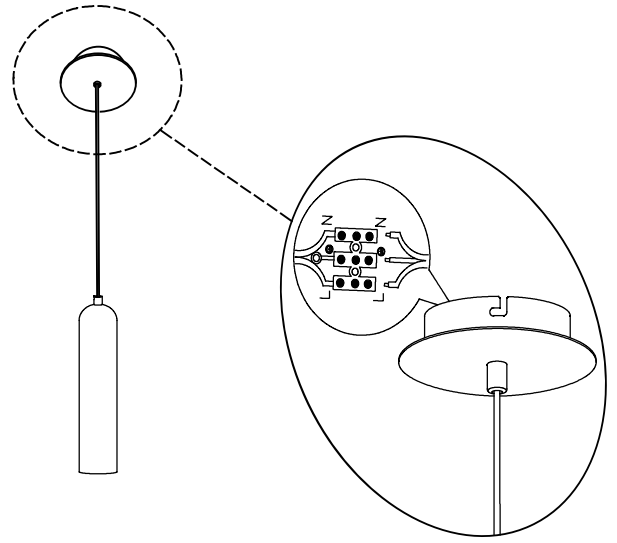

**3**

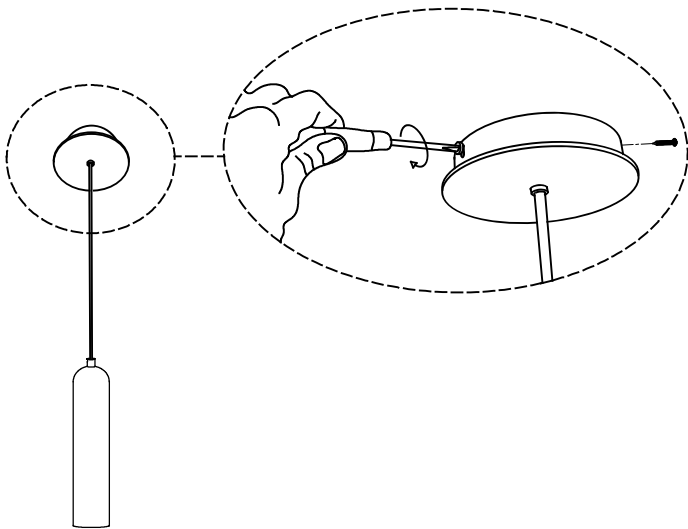

**4**

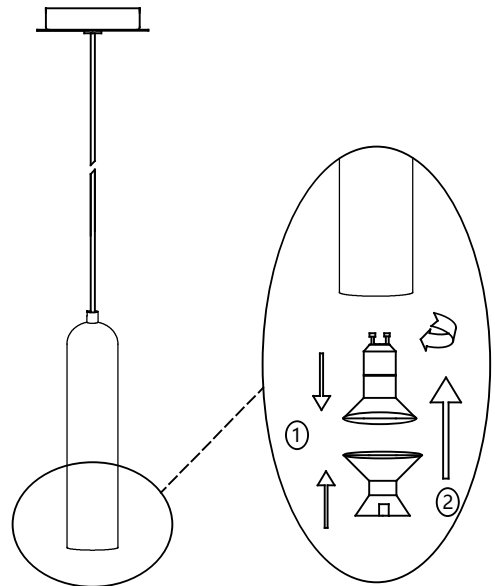

**5**

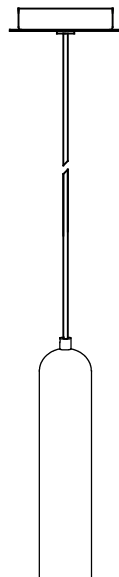

**ON**

