



Romi Reader

DE-0382-SAT

Wall fixture IP20 Romi Reader LED 2.2W 3000K Satin nickel

Installation Instructions

3D File

Revit

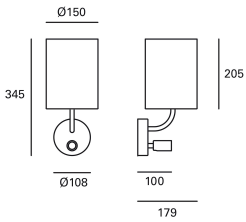

TECHNICAL FEATURES



Power (W)-1 : 2.2W

Power (W)-2 : Max. power 40W

Total power consumption of light (W) : 44W

Colour temperature-1 : LED warm-white 3000K

Structure material : Steel

Structure finish : Satin nickel

Diffuser material : Textile

Diffuser finish : White

Useful life : 36.000h L70B30

Recommended light bulb-2 : E27

Equipment included : Yes, electronic

Voltage / frequency : 100-240V/50-60Hz

Warranty : 5 Years

Max. temperature : 25°C

Energy efficiency : A++

LUMINOTECHNIC FEATURES

Light source: LED CREE

CRI: 80

MacAdam steps: 3

Photobiological risk: RG2

Lampholder: 1 x E27

LOGISTICS

Net weight (kg): 0.65

Packaged weight (kg): 1.38

Packaging: 305mm x 175mm x 245mm



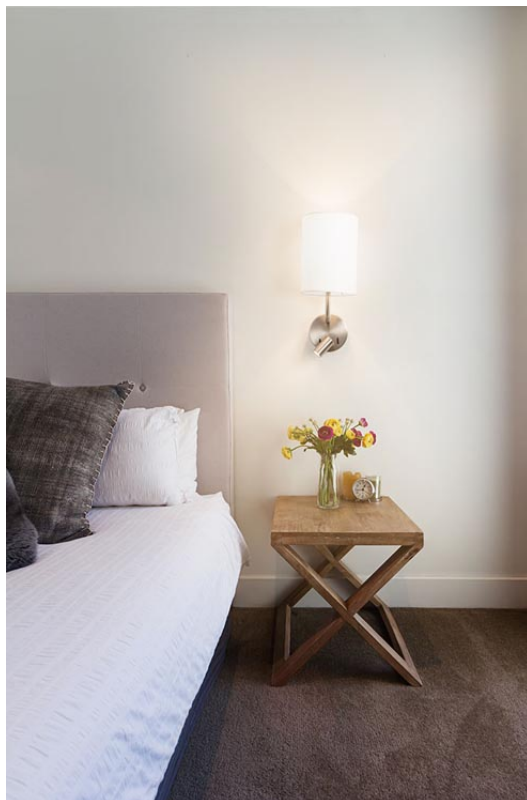

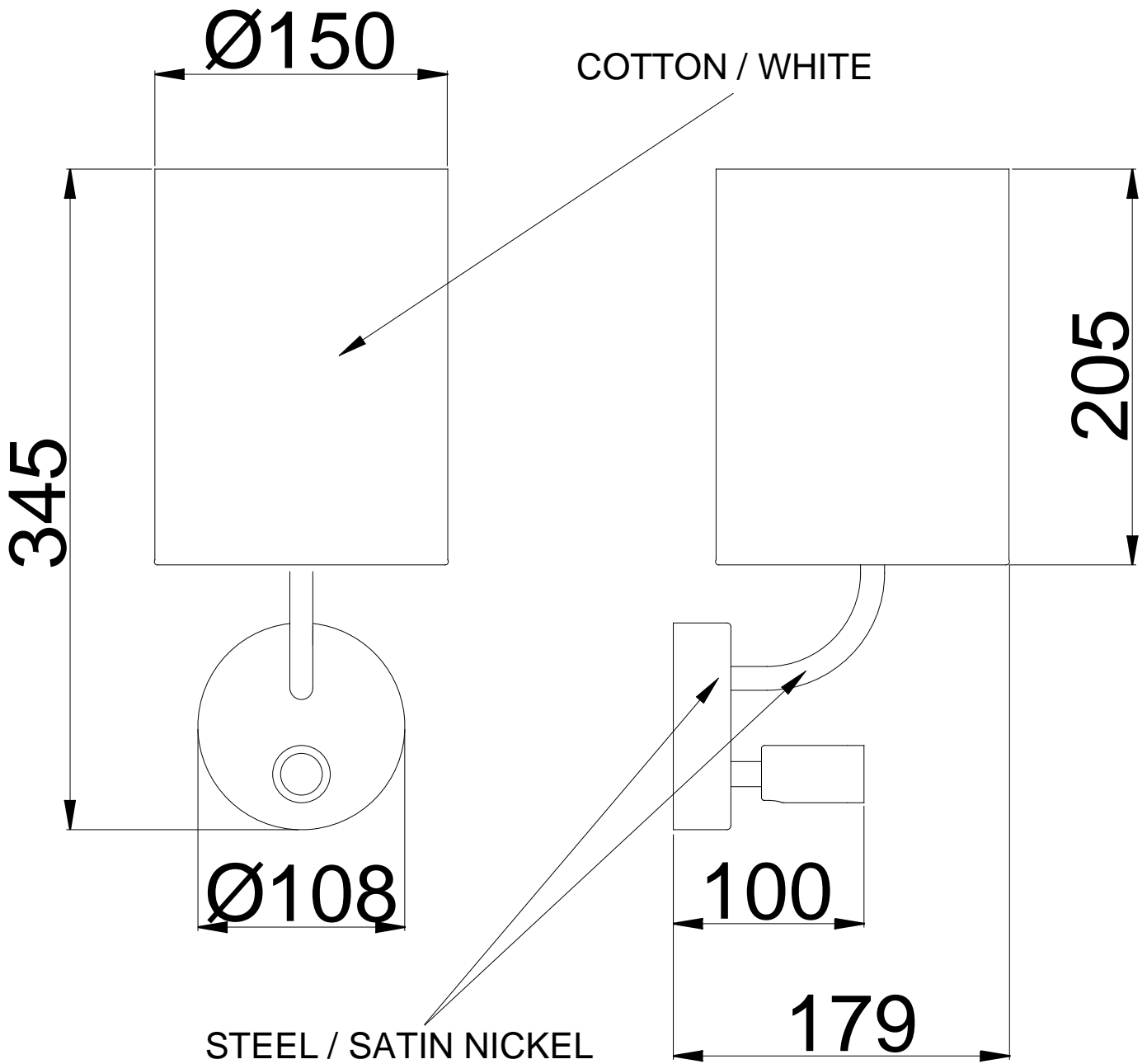

INSTALLATION TEMPLATE

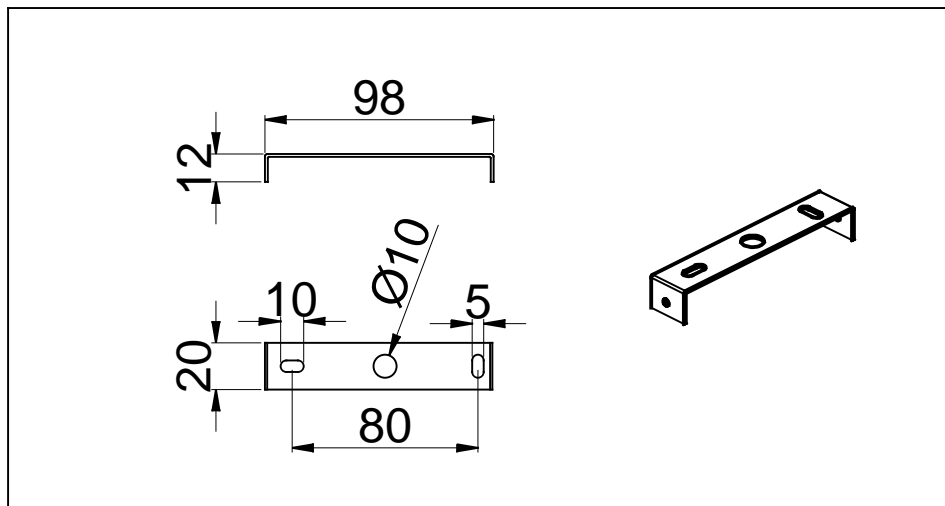

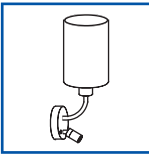

Romi

DE-0382

FOR
LIGHT

