

Easy Round Surface
Ø120mm

LedsC4 Team

TC-0158-BLA

Surface-mounted ceiling light Easy Round Surface Ø120mm IP23 LED 4.6W 3000K ON-OFF White 414lm



TECHNICAL FEATURES

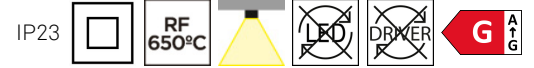

Luminaire total power : 5.6W

Real lumens : 414

Nominal lumens : 580

Real lm/W : 74

Lens / reflector angle : HORIZONTAL 113°

Structure material : Aluminium

Structure finish : White

Diffuser material : Acrylic

Diffuser finish : Opal

Voltage / frequency : 100-240V ~ 50/60Hz

Dimming protocol : ON-OFF

Power Factor : 0.40

Useful life : 36.000h L70B30

Warranty : 5 Years

Easily recyclable luminaire

LUMINOTECHNIC FEATURES

CRI: 80

MacAdam steps: 3

Photobiological risk: RG1

Lampholder	Quantity	Light source power (W)	Correlated Colour Temperature (CCT)
LED	1	4.6W	3000K

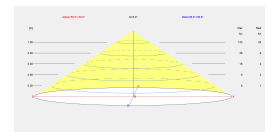
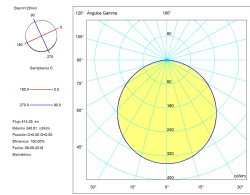

LOGISTICS

Net weight (kg): 0.19

Packaged weight (kg): 0.2

Packaging: 125mm x 45mm x 125mm



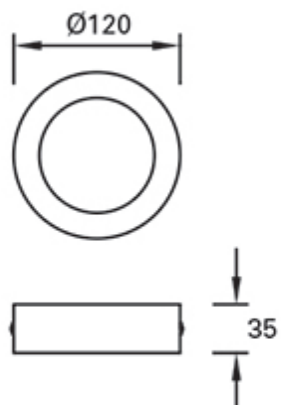

Luminaire

Code TC-0158-BLA
 Name Downlight FORLIGHT leds 4.6W

Measur.

Code TC-0146-BLA
 Name Downlight FORLIGHT leds 4.6W

Luminaire Flux	414.25 lm	Luminaire Power	6.00 W	Efficacy	69.04 lm/W	Efficiency	100.00%
Lamps Flux	414.25 lm	Maximum value	345.81 cd/klm	Position	C=0.00 G=0.00	CG	Double Symmetrical
Round Luminaire Round Luminous Area	Diam. 120 mm Diam. 76 mm	Height	3 mm	Height	0 mm		
Horizontal Luminous Area Emitting area on Plane 0° Emitting area on Plane 90°	0.004536 m2 0.000000 m2 0.000000 m2	Emitting area on Plane 180° Emitting area on Plane 270° Glare area at 76°				0.000000 m2 0.000000 m2 0.001097 m2	
Coordinate system Date Measurement Distance	CG 08-09-2016 0.00	Symmetry Type Maximum Gamma Angle Measurement Flux				Double Symmetrical 90 414.25 lm	
Operator Temperature Humidity Notes	Asselum T3 25.00 °C 60.00 %	Source Voltage [V] Source current [A] Photocell					

Line		Code	Luminaire Lamps		Flux [lm]	Pow. [W]	Q.ty
		TC-0158-BLA	Name	TC-0158-BLA	414.25	6.00	1
C.I.E.	47 78 95 100 100		D DIN 5040		A30		
F UTE	1.00 E		B NBN		BZ 5		

Diam=120mm

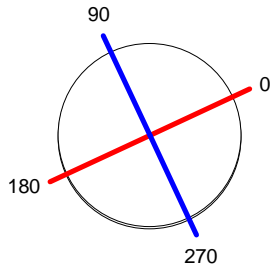

C Halfplanes
 180.0 — 0.0
 270.0 — 90.0

ULOR 0.00 %
 DLOR 100.00 %
 RN 0.00 %

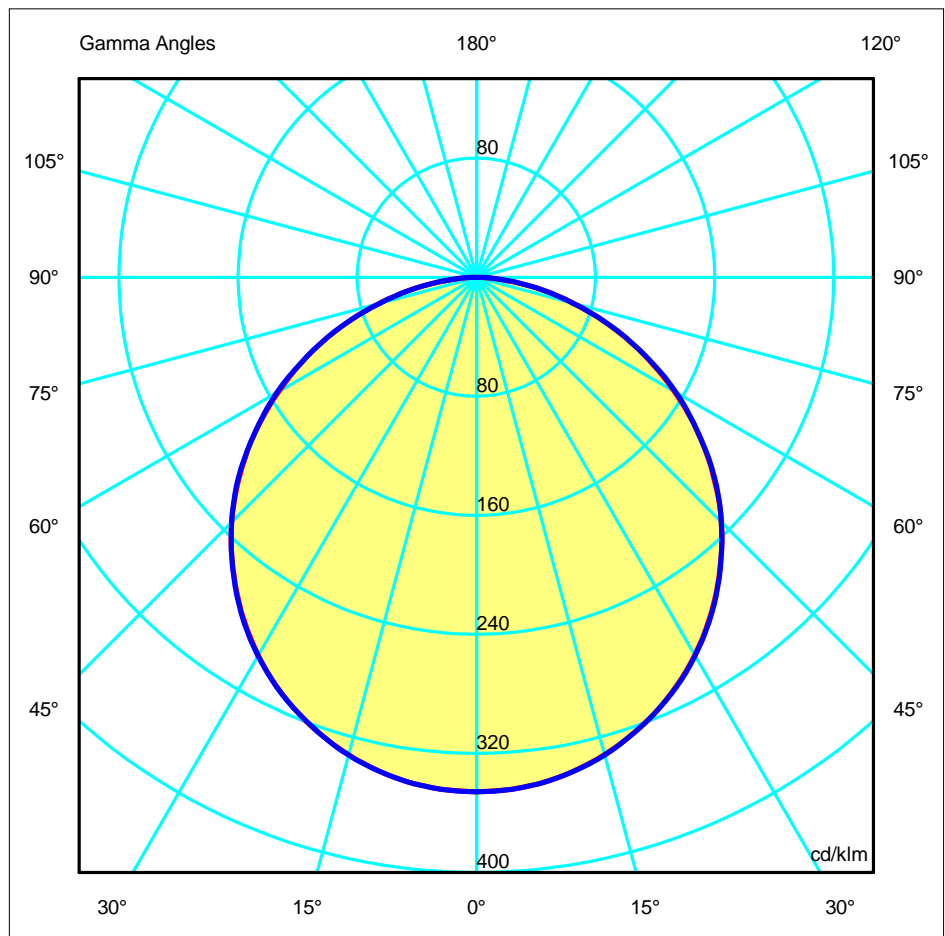



Luminaire

Code TC-0158-BLA
 Name Downlight FORLIGHT leds 4.6W

Measur.

Code TC-0146-BLA
 Name Downlight FORLIGHT leds 4.6W

Luminaire Flux	414.25 lm	Luminaire Power	6.00 W	Efficacy	69.04 lm/W	Efficiency	100.00%
Lamps Flux	414.25 lm	Maximum value	345.81 cd/klm	Position	C=0.00 G=0.00	CG	Double Symmetrical

Luminous Intensity Table cd/klm Table 1/1

	C 0.00	C 15.00	C 30.00	C 45.00	C 60.00	C 75.00	C 90.00
G 0.0	345.81	345.81	345.81	345.81	345.81	345.81	345.81
G 5.0	344.24	344.19	344.26	344.22	344.29	344.27	344.27
G 10.0	339.71	339.78	339.60	339.79	339.79	339.76	339.67
G 15.0	332.07	332.21	332.40	332.31	332.38	332.42	332.39
G 20.0	321.80	322.18	321.91	322.03	321.93	322.17	321.72
G 25.0	308.84	309.03	309.12	309.26	309.05	309.37	309.13
G 30.0	293.11	293.69	293.48	293.74	293.54	293.83	293.53
G 35.0	274.97	275.79	275.40	275.68	275.49	275.81	275.51
G 40.0	254.51	255.25	255.17	255.31	255.08	255.67	254.79
G 45.0	232.62	232.98	232.29	232.72	232.45	232.86	232.51
G 50.0	207.73	208.25	207.82	208.60	208.38	208.33	208.46
G 55.0	181.41	182.58	181.65	182.27	181.82	182.42	181.64
G 60.0	153.24	153.87	154.07	154.49	154.36	154.64	154.81
G 65.0	124.93	125.97	125.23	125.68	125.68	125.88	125.51
G 70.0	96.21	95.99	96.23	96.46	96.43	96.94	96.57
G 75.0	67.42	67.96	67.13	67.80	67.49	68.12	67.15
G 80.0	40.52	40.37	40.41	40.76	40.91	41.19	41.06
G 85.0	16.10	16.45	16.27	16.85	16.72	16.85	16.97
G 90.0	0.68	0.71	0.88	1.33	1.88	2.26	2.38

Luminaire

Code TC-0158-BLA
 Name Downlight FORLIGHT leds 4.6W

Measur.

Code TC-0146-BLA
 Name Downlight FORLIGHT leds 4.6W

Luminaire Flux	414.25 lm	Luminaire Power	6.00 W	Efficacy	69.04 lm/W	Efficiency	100.00%
Lamps Flux	414.25 lm	Maximum value	345.81 cd/klm	Position	C=0.00 G=0.00	CG	Double Symmetrical

Diam=120mm

C Halfplanes

180.0 ——— 0.0
 270.0 ——— 90.0

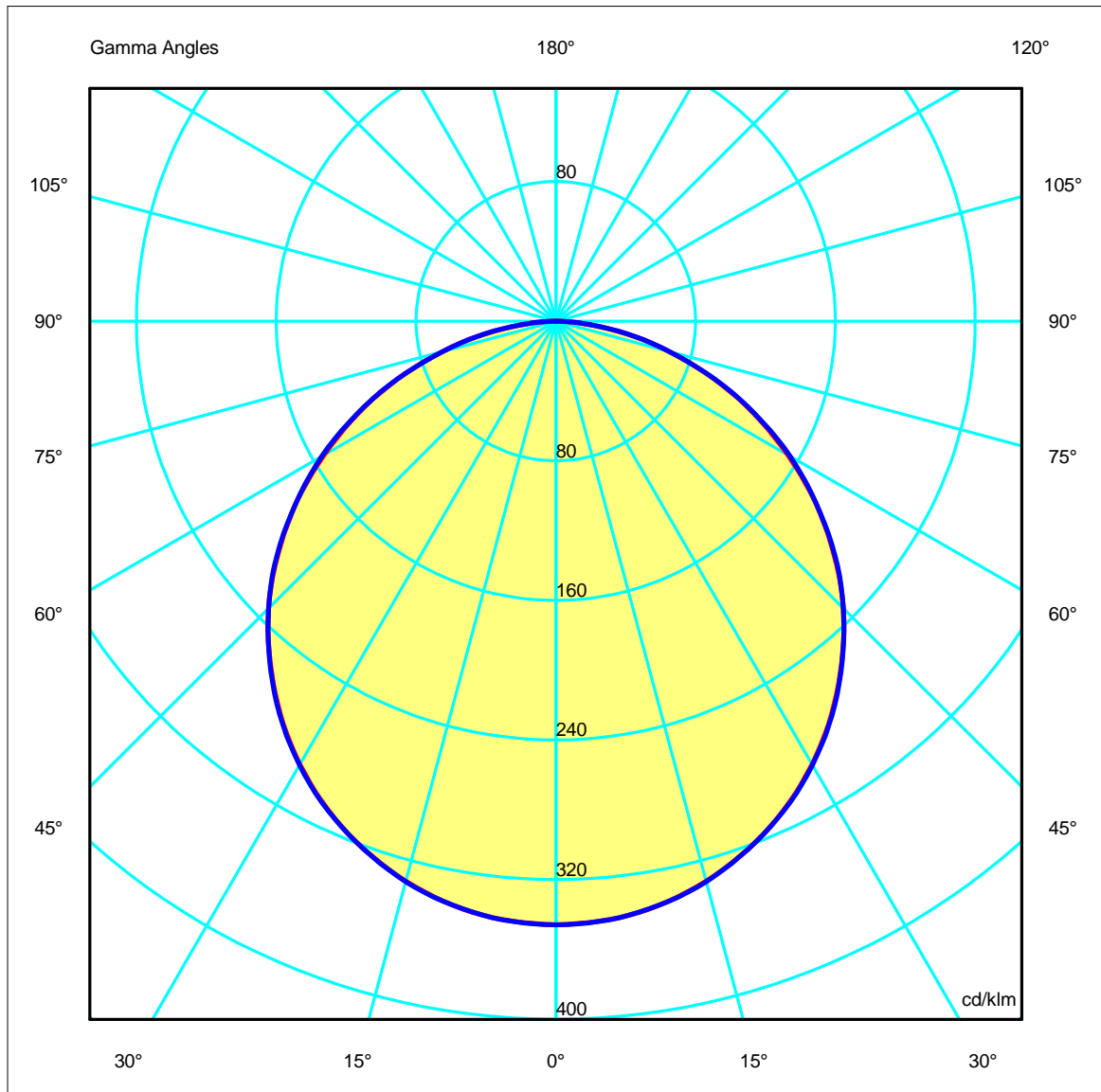
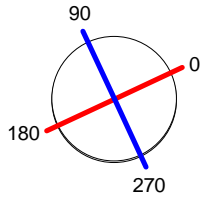

Luminaire

Code TC-0158-BLA
Name Downlight FORLIGHT leds 4.6W

Measur.

Code TC-0146-BLA
Name Downlight FORLIGHT leds 4.6W

Luminaire Flux	414.25 lm	Luminaire Power	6.00 W	Efficacy	69.04 lm/W	Efficiency	100.00%
Lamps Flux	414.25 lm	Maximum value	345.81 cd/klm	Position	C=0.00 G=0.00	CG	Double Symmetrical

Width at 50.00 % of Max Intensity

H[m]	1.00	2.00	3.00	4.00	5.00	H[m]	1.00	2.00	3.00	4.00	5.00
OA	1.51	3.03	4.54	6.05	7.56	OC	1.52	3.04	4.56	6.08	7.60
OB	1.51	3.03	4.54	6.05	7.56	OD	1.52	3.04	4.56	6.08	7.60

	Luminous Intensities [cd/klm]									
	0	5	15	25	35	45	55	65	75	85
OA	143.25	142.60	137.56	127.94	113.90	96.36	75.15	51.75	27.93	6.67
OB	143.25	142.60	137.56	127.94	113.90	96.36	75.15	51.75	27.93	6.67
OC	143.25	142.61	137.69	128.06	114.13	96.32	75.24	51.99	27.82	7.03
OD	143.25	142.61	137.69	128.06	114.13	96.32	75.24	51.99	27.82	7.03

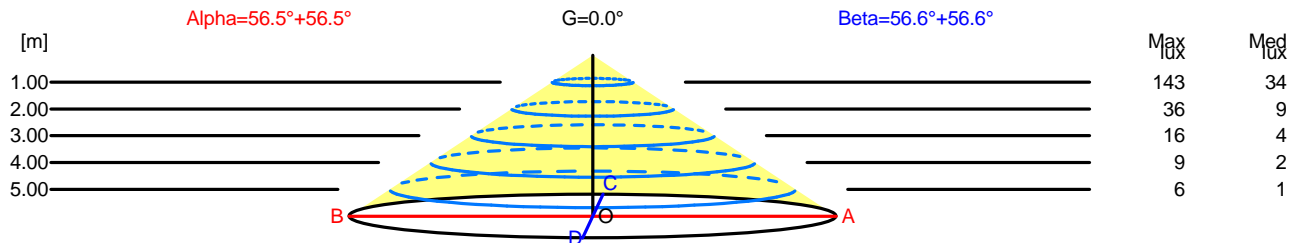

H[m]	D[m]	Max lux	Med lux	Alpha=56.5°+56.5°	G=0.0
1.00	3.03	143	34		
2.00	6.05	36	9		
3.00	9.08	16	4		
4.00	12.10	9	2		
5.00	15.13	6	1		

H[m]	D[m]	Max lux	Med lux	Beta=56.6°+56.6°	G=0.0
1.00	3.04	143	34		
2.00	6.08	36	9		
3.00	9.12	16	4		
4.00	12.15	9	2		
5.00	15.19	6	1		



Luminaire

Code TC-0158-BLA
Name Downlight FORLIGHT leds 4.6W

Measurement

Code TC-0146-BLA
Name Downlight FORLIGHT leds 4.6W

Luminaire Flux	414.25 lm	Luminaire Power	6.00 W	Efficacy	69.04 lm/W	Efficiency	100.00%
Lamps Flux	414.25 lm	Maximum value	345.81 cd/klm	Position	C=0.00 G=0.00	CG	Double Symmetrical

UGR
S = 0.250

Reflectancies										
Ceiling/Cavity	0.7	0.7	0.5	0.5	0.3	0.7	0.7	0.5	0.5	0.3
Walls	0.5	0.3	0.5	0.3	0.3	0.5	0.3	0.5	0.3	0.3
WorkingPlane	0.2	0.2	0.2	0.2	0.2	0.2	0.2	0.2	0.2	0.2
RoomDimensions	ViewedCrosswise					ViewedEndwise				
x=2H y=2H	24.2	25.5	24.5	25.7	26.0	24.2	25.5	24.5	25.7	26.0
x=2H y=3H	25.8	27.0	26.1	27.3	27.6	25.8	27.1	26.2	27.3	27.6
x=2H y=4H	26.5	27.6	26.8	27.9	28.2	26.5	27.7	26.8	27.9	28.2
x=2H y=6H	27.0	28.0	27.3	28.3	28.7	27.0	28.1	27.3	28.3	28.7
x=2H y=8H	27.1	28.1	27.5	28.5	28.8	27.2	28.2	27.5	28.5	28.8
x=2H y=12H	27.2	28.2	27.6	28.5	28.9	27.3	28.2	27.6	28.6	28.9
x=4H y=2H	24.9	26.1	25.3	26.4	26.7	25.0	26.1	25.3	26.4	26.7
x=4H y=3H	26.8	27.7	27.1	28.1	28.4	26.8	27.8	27.2	28.1	28.4
x=4H y=4H	27.6	28.4	28.0	28.8	29.2	27.6	28.4	28.0	28.8	29.2
x=4H y=6H	28.2	28.9	28.6	29.3	29.7	28.2	28.9	28.6	29.3	29.7
x=4H y=8H	28.4	29.1	28.8	29.5	29.9	28.4	29.1	28.8	29.5	29.9
x=4H y=12H	28.5	29.1	29.0	29.5	30.0	28.6	29.2	29.0	29.6	30.0
x=8H y=4H	27.9	28.6	28.3	29.0	29.4	27.9	28.6	28.4	29.0	29.4
x=8H y=6H	28.7	29.2	29.1	29.7	30.1	28.7	29.3	29.2	29.7	30.1
x=8H y=8H	28.9	29.4	29.4	29.9	30.4	29.0	29.5	29.5	29.9	30.4
x=8H y=12H	29.1	29.6	29.6	30.0	30.6	29.2	29.6	29.7	30.1	30.6
x=12H y=4H	28.0	28.6	28.4	29.0	29.4	28.0	28.6	28.4	29.0	29.4
x=12H y=6H	28.7	29.2	29.2	29.7	30.2	28.8	29.3	29.2	29.7	30.2
x=12H y=8H	29.0	29.5	29.5	29.9	30.5	29.1	29.5	29.6	30.0	30.5

Luminaire

Code TC-0158-BLA
 Name Downlight FORLIGHT leds 4.6W

Measur.

Code TC-0146-BLA
 Name Downlight FORLIGHT leds 4.6W

Luminaire Flux	414.25 lm	Luminaire Power	6.00 W	Efficacy	69.04 lm/W	Efficiency	100.00%
Lamps Flux	414.25 lm	Maximum value	345.81 cd/klm	Position	C=0.00 G=0.00	CG	Double Symmetrical

Diam=120mm

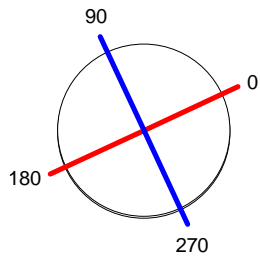

C Halfplanes

180.0 ———— 0.0
 270.0 ———— 90.0

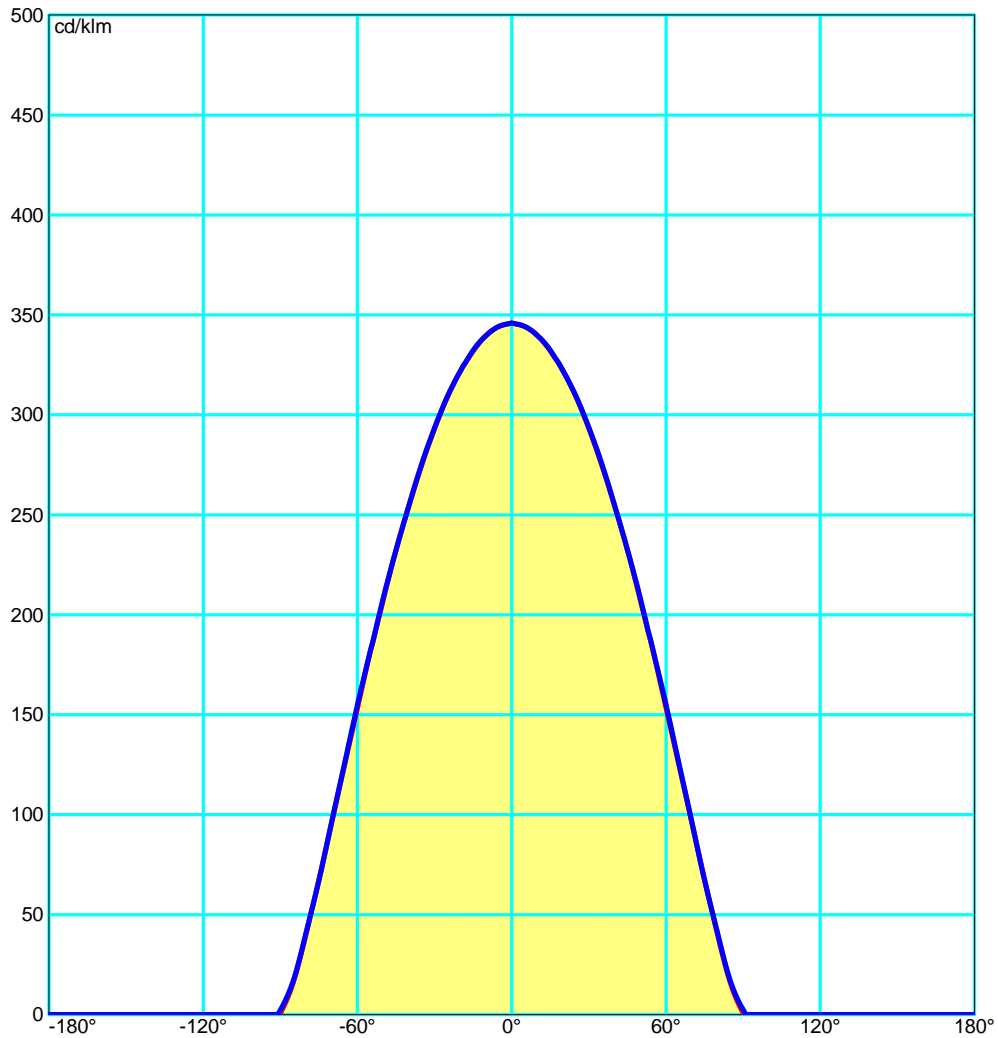

Luminaire
 Code TC-0158-BLA
 Name Downlight FORLIGHT leds 4.6W
Measur.
 Code TC-0146-BLA
 Name Downlight FORLIGHT leds 4.6W

Luminaire Flux	414.25 lm	Luminaire Power	6.00 W	Efficacy	69.04 lm/W	Efficiency	100.00%
Lamps Flux	414.25 lm	Maximum value	345.81 cd/klm	Position	C=0.00 G=0.00	CG	Double Symmetrical

Luminance

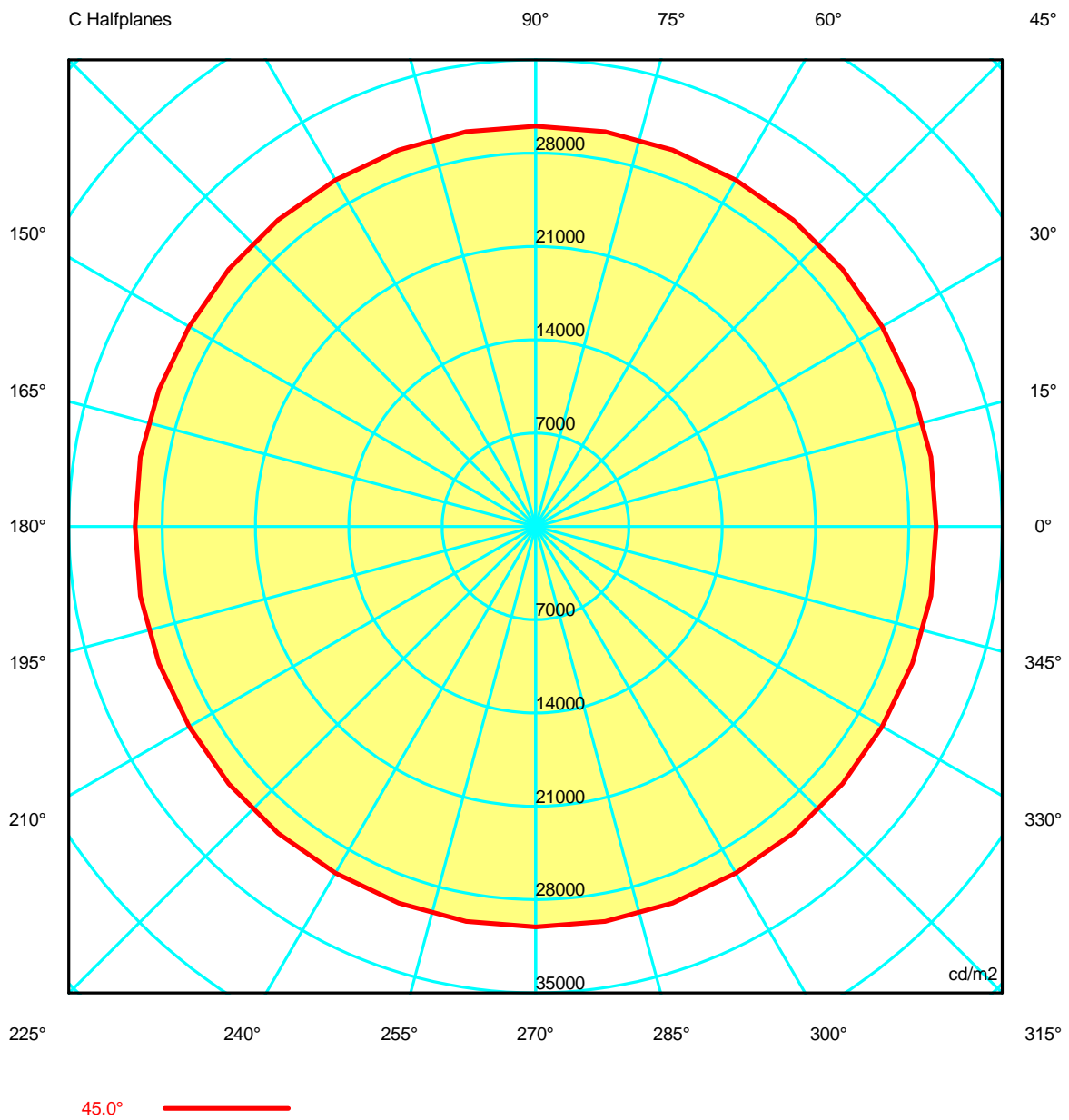



Luminaire

Code TC-0158-BLA
Name Downlight FORLIGHT leds 4.6W

Measur.

Code TC-0146-BLA
Name Downlight FORLIGHT leds 4.6W

Luminaire Flux	414.25 lm	Luminaire Power	6.00 W	Efficacy	69.04 lm/W	Efficiency	100.00%
Lamps Flux	414.25 lm	Maximum value	345.81 cd/klm	Position	C=0.00 G=0.00	CG	Double Symmetrical

Luminance cd/m2 Table 1/3

	C 0.00	C 10.00	C 20.00	C 30.00	C 40.00	C 50.00	C 60.00	C 70.00	C 80.00	C 90.00	C 100.00	C 110.00	C 120.00
G 0.0	31580.64	31580.64	31580.64	31580.64	31580.64	31580.64	31580.64	31580.64	31580.64	31580.64	31580.64	31580.64	31580.64
G 5.0	31557.91	31553.24	31555.16	31559.50	31556.63	31557.11	31562.01	31560.89	31560.32	31560.31	31560.32	31560.89	31562.01
G 10.0	31502.37	31510.57	31503.54	31492.67	31503.32	31509.91	31509.92	31508.50	31505.25	31498.47	31505.25	31508.50	31509.92
G 15.0	31395.76	31403.60	31416.96	31427.54	31421.79	31418.98	31425.51	31429.27	31428.94	31426.41	31428.94	31429.27	31425.51
G 20.0	31274.59	31306.96	31304.85	31284.70	31292.58	31293.89	31287.38	31305.78	31303.88	31266.51	31303.88	31305.78	31287.38
G 25.0	31120.69	31134.82	31142.16	31148.48	31162.25	31155.46	31142.10	31164.26	31173.57	31150.27	31173.57	31164.26	31142.10
G 30.0	30909.38	30960.60	30965.93	30948.16	30968.15	30970.84	30955.03	30975.91	30982.75	30953.99	30982.75	30975.91	30955.03
G 35.0	30655.16	30732.77	30737.81	30703.22	30723.96	30730.29	30713.70	30738.28	30747.29	30716.29	30747.29	30738.28	30713.70
G 40.0	30342.29	30411.39	30431.44	30420.77	30436.05	30425.28	30409.97	30463.32	30465.09	30375.41	30465.09	30463.32	30409.97
G 45.0	30043.30	30093.02	30060.67	30000.40	30037.45	30050.02	30021.72	30056.88	30072.14	30029.74	30072.14	30056.88	30021.72
G 50.0	29512.96	29581.19	29564.82	29526.39	29601.40	29627.01	29605.69	29594.31	29604.34	29617.57	29604.34	29594.31	29605.69
G 55.0	28884.46	29049.40	29028.69	28922.12	28988.29	29005.98	28949.35	29015.87	29030.98	28920.74	29030.98	29015.87	28949.35
G 60.0	27989.50	28075.20	28117.54	28140.05	28198.03	28214.31	28193.64	28223.40	28260.57	28276.86	28260.57	28223.40	28193.64
G 65.0	26997.15	27191.55	27180.41	27061.41	27126.26	27158.97	27159.56	27191.22	27188.95	27121.72	27188.95	27191.22	27159.56
G 70.0	25689.56	25639.93	25642.23	25696.28	25749.05	25753.61	25747.27	25847.79	25879.27	25784.92	25879.27	25847.79	25747.27
G 75.0	23790.67	23981.82	23880.71	23685.90	23846.86	23903.59	23814.06	23979.44	23991.51	23693.77	23991.51	23979.44	23814.06
G 80.0	21312.74	21254.23	21219.23	21252.92	21380.37	21467.82	21512.76	21622.21	21662.98	21592.34	21662.98	21622.21	21512.76
G 85.0	16868.49	17198.50	17158.02	17044.15	17465.53	17608.61	17519.14	17582.17	17714.84	17777.93	17714.84	17582.17	17519.14
G 90.0	0.00	0.00	0.00	0.00	0.00	0.00	0.00	0.00	0.00	0.00	0.00	0.00	0.00



Luminaire

Code TC-0158-BLA
Name Downlight FORLIGHT leds 4.6W

Measur.

Code TC-0146-BLA
Name Downlight FORLIGHT leds 4.6W

Luminaire Flux	414.25 lm	Luminaire Power	6.00 W	Efficacy	69.04 lm/W	Efficiency	100.00%
Lamps Flux	414.25 lm	Maximum value	345.81 cd/klm	Position	C=0.00 G=0.00	CG	Double Symmetrical

Luminance cd/m2 Table 2/3

	C 130.00	C 140.00	C 150.00	C 160.00	C 170.00	C 180.00	C 190.00	C 200.00	C 210.00	C 220.00	C 230.00	C 240.00	C 250.00
G 0.0	31580.64	31580.64	31580.64	31580.64	31580.64	31580.64	31580.64	31580.64	31580.64	31580.64	31580.64	31580.64	31580.64
G 5.0	31557.11	31556.63	31559.50	31555.16	31553.24	31557.91	31553.24	31555.16	31559.50	31556.63	31557.11	31562.01	31560.89
G 10.0	31509.91	31503.32	31492.67	31503.54	31510.57	31502.37	31510.57	31503.54	31492.67	31503.32	31509.91	31509.92	31508.50
G 15.0	31418.98	31421.79	31427.54	31416.96	31403.60	31395.76	31403.60	31416.96	31427.54	31421.79	31418.98	31425.51	31429.27
G 20.0	31293.89	31292.58	31284.70	31304.85	31306.96	31274.59	31306.96	31304.85	31284.70	31292.58	31293.89	31287.38	31305.78
G 25.0	31155.46	31162.25	31148.48	31142.16	31134.82	31120.69	31134.82	31142.16	31148.48	31162.25	31155.46	31142.10	31164.26
G 30.0	30970.84	30968.15	30948.16	30965.93	30960.60	30909.38	30960.60	30965.93	30948.16	30968.15	30970.84	30955.03	30975.91
G 35.0	30730.29	30723.96	30703.22	30737.81	30732.77	30655.16	30732.77	30737.81	30703.22	30723.96	30730.29	30713.70	30738.28
G 40.0	30425.28	30436.05	30420.77	30431.44	30411.39	30342.29	30411.39	30431.44	30420.77	30436.05	30425.28	30409.97	30463.32
G 45.0	30050.02	30037.45	30000.40	30060.67	30093.02	30043.30	30093.02	30060.67	30000.40	30037.45	30050.02	30021.72	30056.88
G 50.0	29627.01	29601.40	29526.39	29564.82	29581.19	29512.96	29581.19	29564.82	29526.39	29601.40	29627.01	29605.69	29594.31
G 55.0	29005.98	28988.29	28922.12	29028.69	29049.40	28884.46	29049.40	29028.69	28922.12	28988.29	29005.98	28949.35	29015.87
G 60.0	28214.31	28198.03	28140.05	28117.54	28075.20	27989.50	28075.20	28117.54	28140.05	28198.03	28214.31	28193.64	28223.40
G 65.0	27158.97	27126.26	27061.41	27180.41	27191.55	26997.15	27191.55	27180.41	27061.41	27126.26	27158.97	27159.56	27191.22
G 70.0	25753.61	25749.05	25696.28	25642.23	25639.93	25689.56	25639.93	25642.23	25696.28	25749.05	25753.61	25747.27	25847.79
G 75.0	23903.59	23846.86	23685.90	23880.71	23981.82	23790.67	23981.82	23880.71	23685.90	23846.86	23903.59	23814.06	23979.44
G 80.0	21467.82	21380.37	21252.92	21219.23	21254.23	21312.74	21254.23	21219.23	21252.92	21380.37	21467.82	21512.76	21622.21
G 85.0	17608.61	17465.53	17044.15	17158.02	17198.50	16868.49	17198.50	17158.02	17044.15	17465.53	17608.61	17519.14	17582.17
G 90.0	0.00	0.00	0.00	0.00	0.00	0.00	0.00	0.00	0.00	0.00	0.00	0.00	0.00



Luminaire

Code TC-0158-BLA
Name Downlight FORLIGHT leds 4.6W

Measur.

Code TC-0146-BLA
Name Downlight FORLIGHT leds 4.6W

Luminaire Flux	414.25 lm	Luminaire Power	6.00 W	Efficacy	69.04 lm/W	Efficiency	100.00%
Lamps Flux	414.25 lm	Maximum value	345.81 cd/klm	Position	C=0.00 G=0.00	CG	Double Symmetrical

Luminance cd/m2 Table 3/3

	C 260.00	C 270.00	C 280.00	C 290.00	C 300.00	C 310.00	C 320.00	C 330.00	C 340.00	C 350.00
G 0.0	31580.64	31580.64	31580.64	31580.64	31580.64	31580.64	31580.64	31580.64	31580.64	31580.64
G 5.0	31560.32	31560.31	31560.32	31560.89	31562.01	31557.11	31556.63	31559.50	31555.16	31553.24
G 10.0	31505.25	31498.47	31505.25	31508.50	31509.92	31509.91	31503.32	31492.67	31503.54	31510.57
G 15.0	31428.94	31426.41	31428.94	31429.27	31425.51	31418.98	31421.79	31427.54	31416.96	31403.60
G 20.0	31303.88	31266.51	31303.88	31305.78	31287.38	31293.89	31292.58	31284.70	31304.85	31306.96
G 25.0	31173.57	31150.27	31173.57	31164.26	31142.10	31155.46	31162.25	31148.48	31142.16	31134.82
G 30.0	30982.75	30953.99	30982.75	30975.91	30955.03	30970.84	30968.15	30948.16	30965.93	30960.60
G 35.0	30747.29	30716.29	30747.29	30738.28	30713.70	30730.29	30723.96	30703.22	30737.81	30732.77
G 40.0	30465.09	30375.41	30465.09	30463.32	30409.97	30425.28	30436.05	30420.77	30431.44	30411.39
G 45.0	30072.14	30029.74	30072.14	30056.88	30021.72	30050.02	30037.45	30000.40	30060.67	30093.02
G 50.0	29604.34	29617.57	29604.34	29594.31	29605.69	29627.01	29601.40	29526.39	29564.82	29581.19
G 55.0	29030.98	28920.74	29030.98	29015.87	28949.35	29005.98	28988.29	28922.12	29028.69	29049.40
G 60.0	28260.57	28276.86	28260.57	28223.40	28193.64	28214.31	28198.03	28140.05	28117.54	28075.20
G 65.0	27188.95	27121.72	27188.95	27191.22	27159.56	27158.97	27126.26	27061.41	27180.41	27191.55
G 70.0	25879.27	25784.92	25879.27	25847.79	25747.27	25753.61	25749.05	25696.28	25642.23	25639.93
G 75.0	23991.51	23693.77	23991.51	23979.44	23814.06	23903.59	23846.86	23685.90	23880.71	23981.82
G 80.0	21662.98	21592.34	21662.98	21622.21	21512.76	21467.82	21380.37	21252.92	21219.23	21254.23
G 85.0	17714.84	17777.93	17714.84	17582.17	17519.14	17608.61	17465.53	17044.15	17158.02	17198.50
G 90.0	0.00	0.00	0.00	0.00	0.00	0.00	0.00	0.00	0.00	0.00

Luminaire
 Code TC-0158-BLA
 Name Downlight FORLIGHT leds 4.6W
Measur.
 Code TC-0146-BLA
 Name Downlight FORLIGHT leds 4.6W

Luminaire Flux	414.25 lm	Luminaire Power	6.00 W	Efficacy	69.04 lm/W	Efficiency	100.00%
Lamps Flux	414.25 lm	Maximum value	345.81 cd/klm	Position	C=0.00 G=0.00	CG	Double Symmetrical

PERCENTAGE ISOCANDLES

Projection: Equal Area SLI (glare) 7.1 Tight Tilting Angle:0°

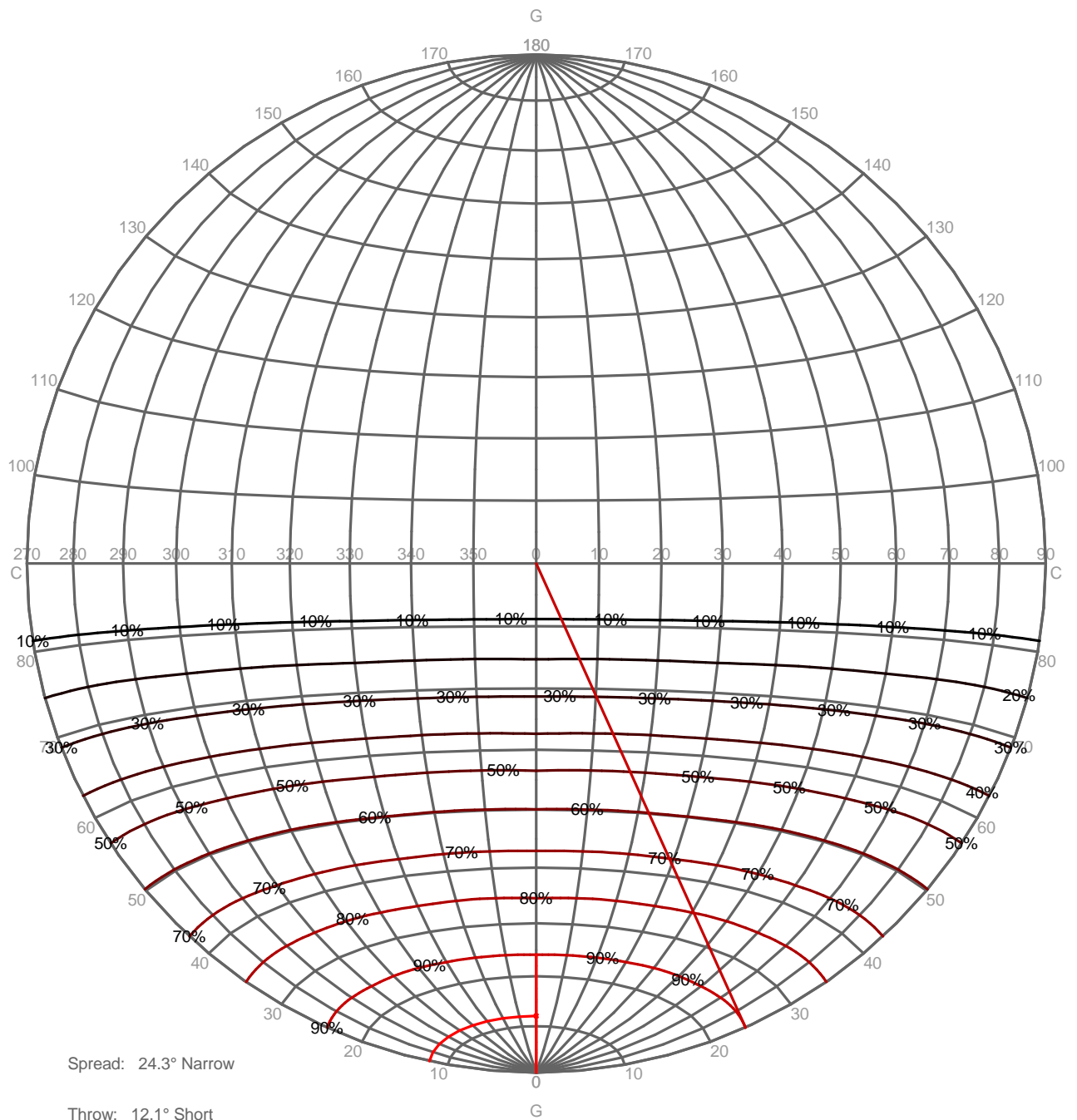

Luminaire

Code TC-0158-BLA
 Name Downlight FORLIGHT leds 4.6W

Measur.

Code TC-0146-BLA
 Name Downlight FORLIGHT leds 4.6W

Luminaire Flux	414.25 lm	Luminaire Power	6.00 W	Efficacy	69.04 lm/W	Efficiency	100.00%
Lamps Flux	414.25 lm	Maximum value	345.81 cd/klm	Position	C=0.00 G=0.00	CG	Double Symmetrical

Isolux (Floor)

Luminaire position X=0.00m Y=0.00m Z=2.50m

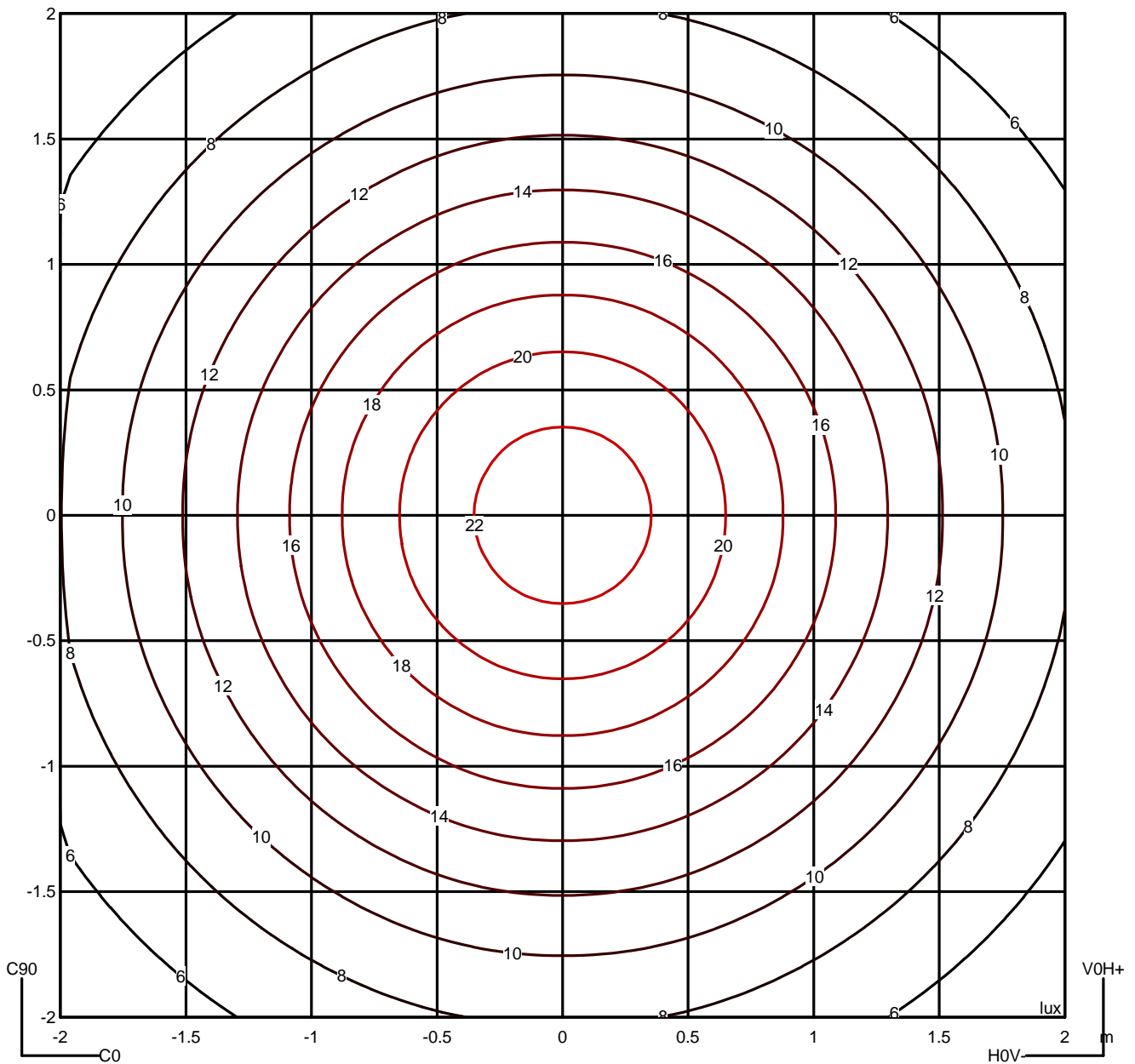

Luminaire

Code TC-0158-BLA
 Name Downlight FORLIGHT leds 4.6W

Measur.

Code TC-0146-BLA
 Name Downlight FORLIGHT leds 4.6W

Luminaire Flux	414.25 lm	Luminaire Power	6.00 W	Efficacy	69.04 lm/W	Efficiency	100.00%
Lamps Flux	414.25 lm	Maximum value	345.81 cd/klm	Position	C=0.00 G=0.00	CG	Double Symmetrical

		Average Luminance [cd/m ²]									
		45°	50°	55°	60°	65°	70°	75°	80°	85°	
0.0°		30043	29513	28884	27989	26997	25690	23791	21313	16868	---
90.0°		30030	29618	28921	28277	27122	25785	23694	21592	17778	---

Flush mounted or longitudinal view												
		Illumination(Ix)										
A	A	2000	1000	750	500		<300					1.15
B	1		2000	1500	1000	750	500	<300				1.5
C					2000		1000	500	<300			1.85
D	2						2000	1000	500	<300		2.2
E	3							2000	1000	500	<300	2.55

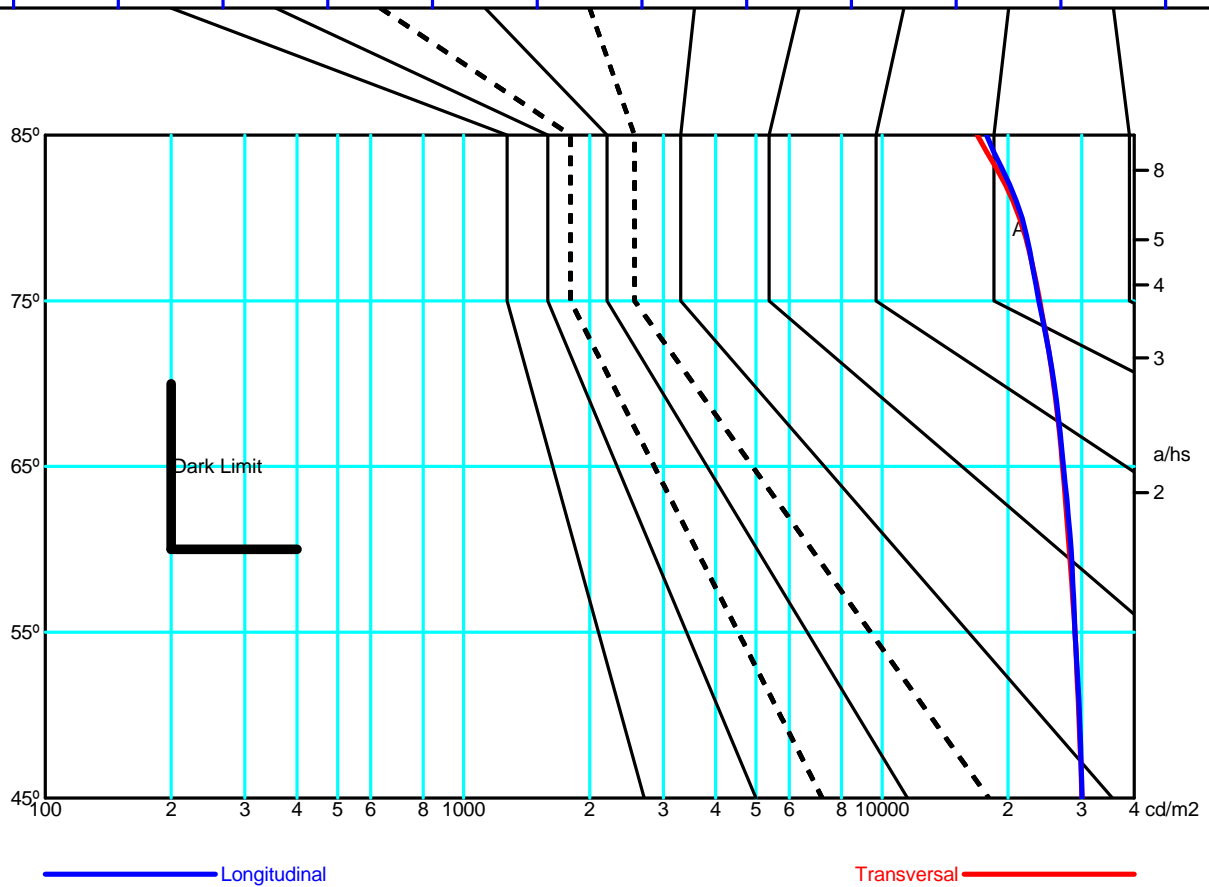

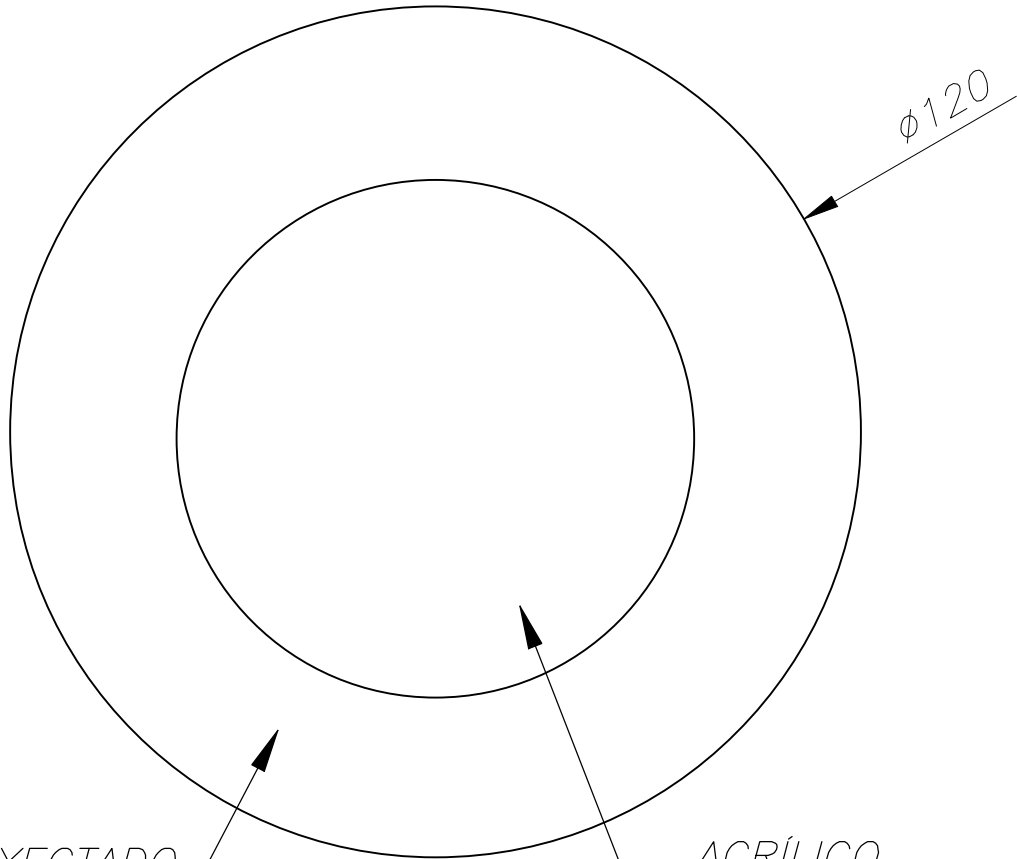

ALUMINIO INYECTADO
INJECTED ALUMINIUM

ACRÍLICO
OPAL

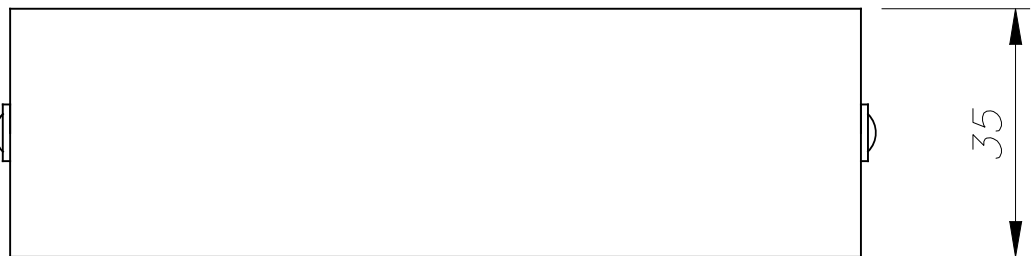

PLANTILLA DE INSTALACIÓN
INSTALLATION TEMPLATE

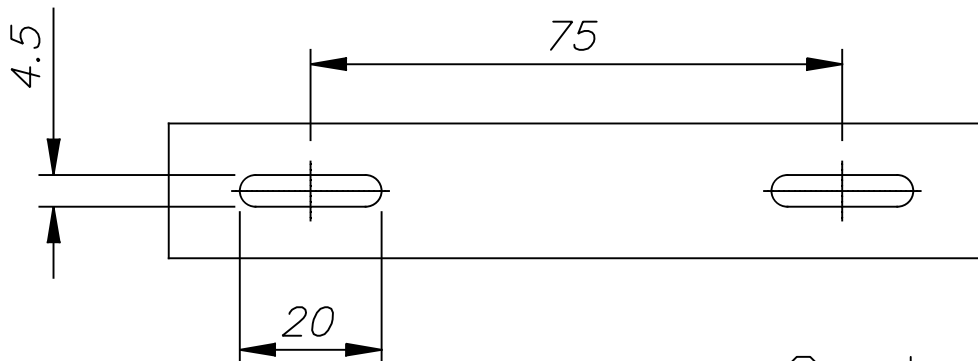

Scale 1:1

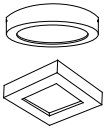

Easy

FOR LIGHT

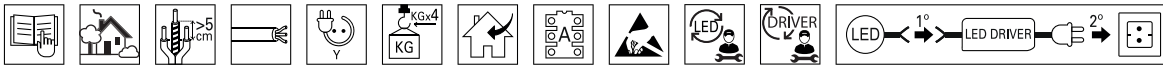

	Ø120	Ø170	Ø225	Ø300	Ø400	122x122	170x170	225x225	400x400
	50 mm	110 mm	170 mm	235 mm	290 mm	70 mm	120 mm	170 mm	290 mm

